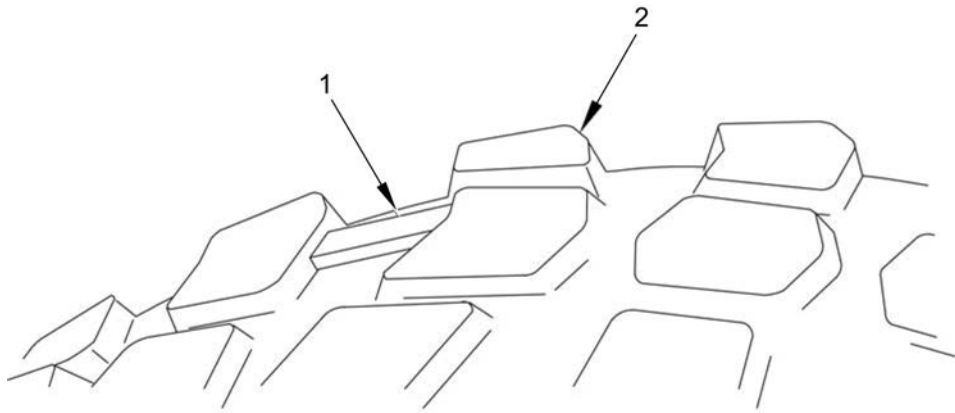


Table 1. PMCS — Before

ITEM NO.	INTERVAL	ITEM TO BE CHECKED OR SERVICED	PROCEDURE	EQUIPMENT NOT READY/ AVAILABLE IF:
1	Before	Exterior of Trailer	1. Look under trailer for signs of fluid leakage (grease or water).	Class III leak is evident.
2	Before	Wheels and Tires	1. Check tire tread depth (Figure 1, Item 2). Tread depth should not be worn beyond level of wear bar (Figure 1, Item 1).	Tire tread (Figure 1, Item 2) is worn even to height of wear bar (Figure 1, Item 1) (depth is 1/8 in. (0.3 cm) or less). Any cut, gouge, or crack that extends to cord body or any unusual bulges.



T4300E21

Figure 1. Check Tire Treads.

			<p>2. Check wheel assembly for damage. If damaged, remove wheel and check wheel for cracked, broken, or bent surfaces.</p> <p>3. Check wheel studs (Figure 2, Item 1) and nuts (Figure 2, Item 2) for obvious looseness. Check for bent or broken studs and missing or loose nuts. Notify Field Level Maintenance if any nuts are loose or missing or if any studs are broken or bent.</p>	<p>Wheel is cracked, broken, or bent.</p> <p>Two or more nuts or studs on same wheel are missing, loose, or broken.</p>
--	--	--	--	---

Table 1. PMCS — Before - Continued

ITEM NO.	INTERVAL	ITEM TO BE CHECKED OR SERVICED	PROCEDURE	EQUIPMENT NOT READY/ AVAILABLE IF:
			<div data-bbox="516 390 967 821" data-label="Image"> <p>The diagram shows a top-down view of a wheel hub assembly. It features a central hub with a circular pattern of mounting points. Two callout lines are present: callout '1' points to a bolt on the outer rim of the hub, and callout '2' points to a nut on the inner hub. The entire assembly is surrounded by concentric dashed lines representing the tire and wheel rim.</p> </div> <div data-bbox="1110 827 1200 852" data-label="Text"> <p>T4300E22</p> </div> <div data-bbox="625 909 1086 945" data-label="Caption"> <p>Figure 2. Check Wheel Studs and Nuts.</p> </div> <div data-bbox="630 976 1208 1089" data-label="List-Group"> <ol style="list-style-type: none"> 4. Check tire pressure with tire inflator/gage for applicable setting. <ol style="list-style-type: none"> a. BOTH MODELS: HIGHWAY 77 psi (531 kPa). </div>	

Table 1. PMCS — Before - Continued

ITEM NO.	INTERVAL	ITEM TO BE CHECKED OR SERVICED	PROCEDURE	EQUIPMENT NOT READY/ AVAILABLE IF:
3	Before	Coupler Seals on Trailer and Towing Vehicle Gladhands	1. Check that coupler seals (Figure 3, Item 1) on gladhands are free of dirt, sand, or other abrasive materials. Clean if dirt, sand, or other abrasive materials are present ((WP 0053), General Cleaning Instructions).	

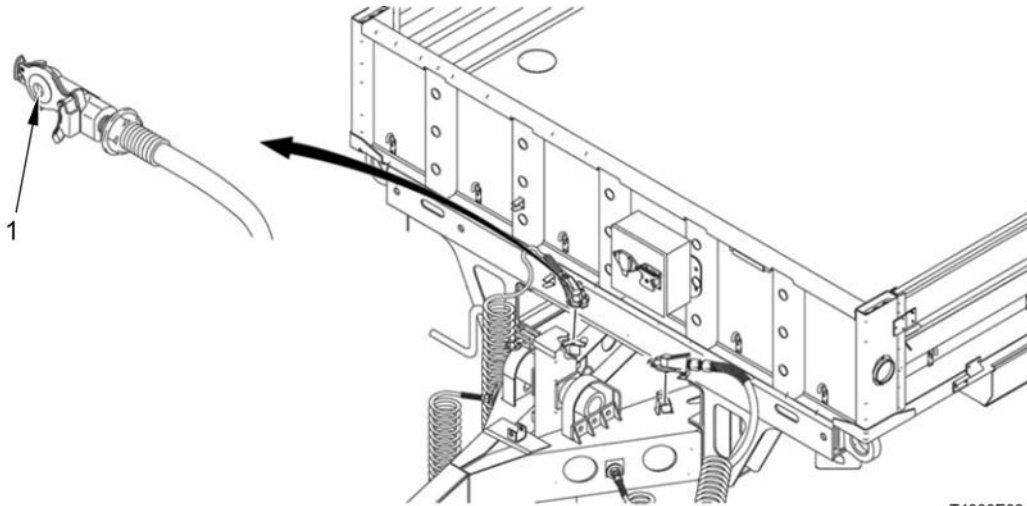


Figure 3. Check Gladhand Coupler Seals.

Table 1. PMCS — Before - Continued

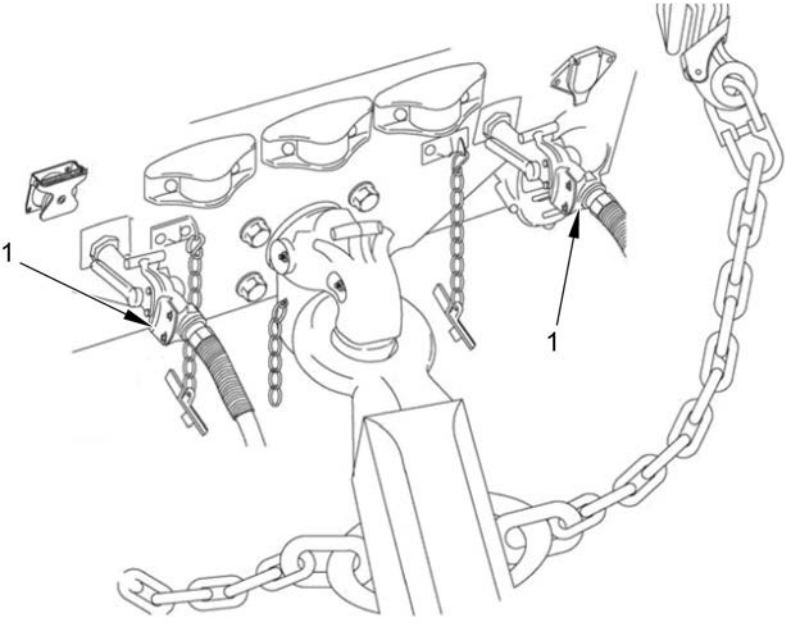
ITEM NO.	INTERVAL	ITEM TO BE CHECKED OR SERVICED	PROCEDURE	EQUIPMENT NOT READY/ AVAILABLE IF:
4	Before	SERVICE and EMERGENCY Gladhand Hoses with Trailer Coupled to Towing Vehicle	1. Check that SERVICE and EMERGENCY gladhand hoses (Figure 4, Item 1) are securely connected to towing vehicle.	Both SERVICE and EMERGENCY gladhand hoses cannot be securely connected to towing vehicle.
<div style="text-align: center;">  </div> <p style="text-align: right; margin-right: 100px;">T4300E04</p>				
			2. Check SERVICE and EMERGENCY gladhand hoses (Figure 5, Item 1) and gladhands (Figure 5, Item 2) for leaks and other obvious damage, such as cuts or breaks.	SERVICE and EMERGENCY gladhand hoses and gladhands are leaking or damaged.

Figure 4. Check Service Gladhand Hoses.

Table 1. PMCS — Before - Continued

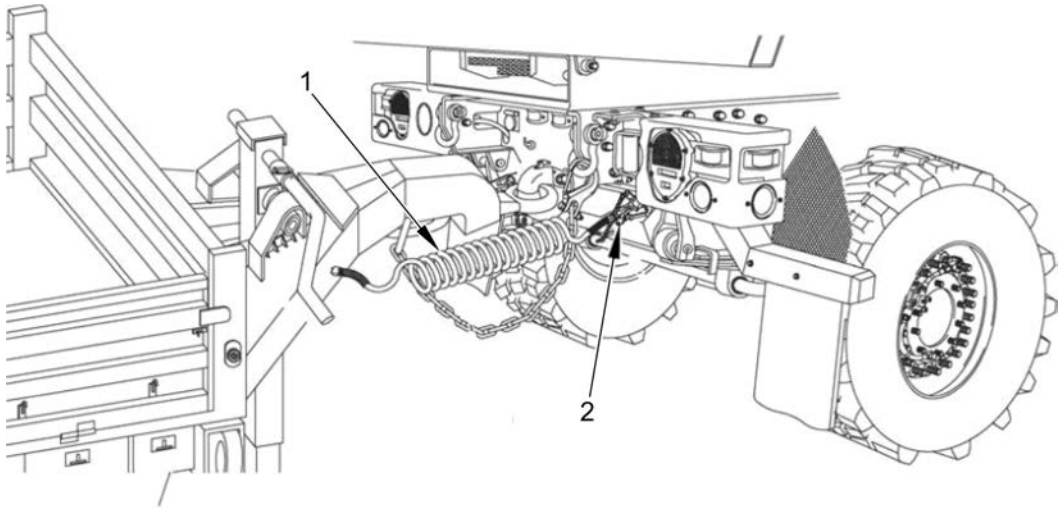
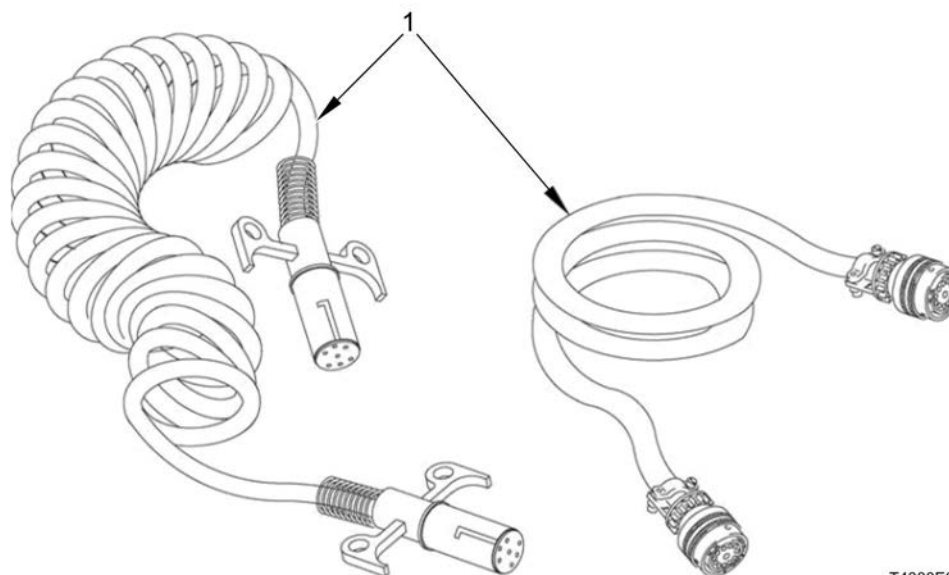
ITEM NO.	INTERVAL	ITEM TO BE CHECKED OR SERVICED	PROCEDURE	EQUIPMENT NOT READY/ AVAILABLE IF:
 <p style="text-align: right; margin-right: 50px;">T4300E05</p>				
<p>Figure 5. Check Service and Emergency Gladhand Hoses for Leaks, Cuts or Breaks.</p>				

Table 1. PMCS — Before - Continued

ITEM NO.	INTERVAL	ITEM TO BE CHECKED OR SERVICED	PROCEDURE	EQUIPMENT NOT READY/ AVAILABLE IF:
5	Before	Intervehicular Cable with Trailer Coupled to Towing Vehicle	<p style="text-align: center;">NOTE</p> <p>The trailer voltage converter box will accommodate 12 vdc, 7-pin or 24 vdc, 12-pin intervehicular cables (WP 0004).</p> <p>1. Check for secure attachment of intervehicular cable (Figure 6, Item 1) to trailer and towing vehicle.</p> <p>2. Check intervehicular cable (Figure 6, Item 1) for cracked insulation or bare wires.</p>	<p>Intervehicular cable cannot be securely connected to trailer and towing vehicle.</p> <p>Intervehicular cable has cracked insulation or bare wires.</p>



T4300E06

Figure 6. Check Intervehicular Cable.

Table 1. PMCS — Before - Continued

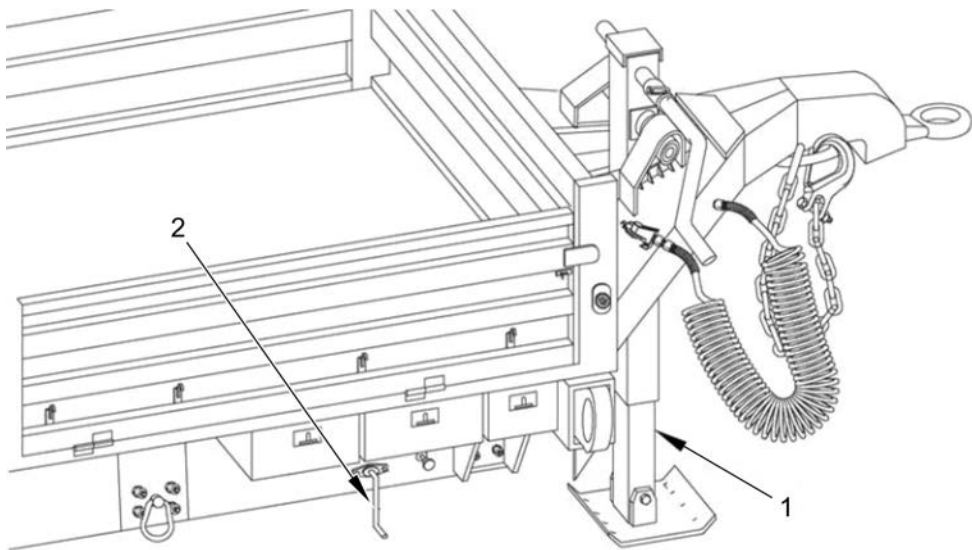
ITEM NO.	INTERVAL	ITEM TO BE CHECKED OR SERVICED	PROCEDURE	EQUIPMENT NOT READY/ AVAILABLE IF:
6	Before	Landing Gear	<ol style="list-style-type: none"> 1. Inspect landing gear (Figure 7, Item 1) for damaged, loose, or missing parts. Ensure landing gear is in good repair. 2. Attempt to operate landing gear winch handle (Figure 7, Item 2) to check for damage and/or misalignment. If misaligned, attempt to realign. 	Landing gear does not operate properly.
 <p style="text-align: right; margin-right: 50px;">T4300E07</p>				
<p>Figure 7. Inspect Landing Gear.</p>			<ol style="list-style-type: none"> 3. Attempt to operate landing gear handle (Figure 8, Item 1) to check for damage and/or misalignment. If misaligned, attempt to realign. 4. Attempt to drop and raise landing gear (Figure 8, Item 2). 5. Attempt to lower and raise footplate (Figure 8, Item 3). 	<p>Landing gear handle is damaged and/or cannot be realigned.</p> <p>Landing gear cannot be lowered and/or raised.</p> <p>Footplate cannot be lowered and/or raised.</p>

Table 1. PMCS — Before - Continued

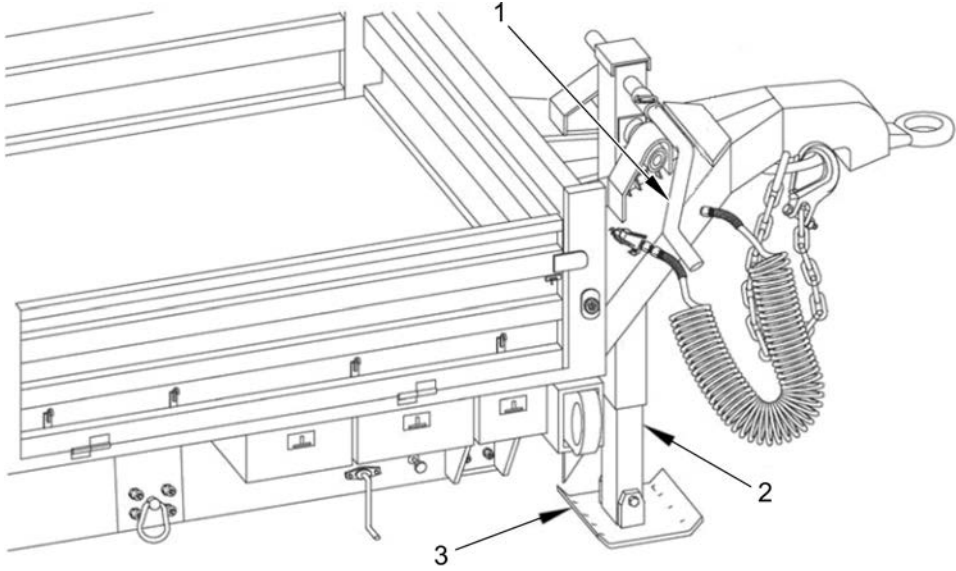
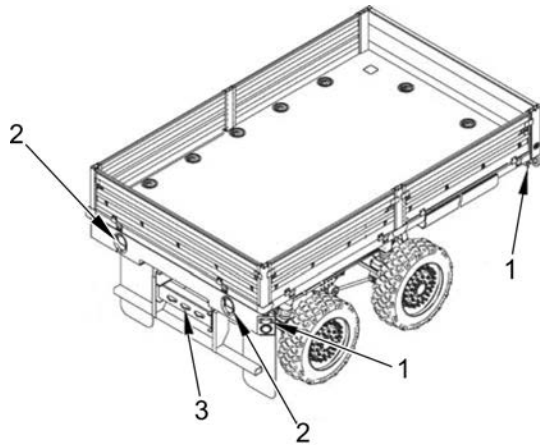
ITEM NO.	INTERVAL	ITEM TO BE CHECKED OR SERVICED	PROCEDURE	EQUIPMENT NOT READY/ AVAILABLE IF:
 <p style="text-align: right; margin-right: 50px;">T4300E08</p>				
<p>Figure 8. Attempt to Operate Landing Gear to Check for Damage.</p>				

Table 1. PMCS — Before - Continued

ITEM NO.	INTERVAL	ITEM TO BE CHECKED OR SERVICED	PROCEDURE	EQUIPMENT NOT READY/ AVAILABLE IF:
7	Before	Trailer Lights/ABS Diagnostic Tool	<ol style="list-style-type: none"> 1. Couple trailer to towing vehicle (WP 0008). 2. Position the main light switch of the towing vehicle to the appropriate position. 3. Check trailer clearance lights (Figure 9, Item 1), marker lights (Figure 9, Item 3), turn signals (Figure 9, Item 2), taillights (Figure 9, Item 2), stoplights (Figure 9, Item 2), blackout marker lights (Figure 9, Item 3), and blackout stop lights (Figure 9, Item 2) for damage and proper operation (WP 0006). 	<p>One or more trailer marker lights, turn signals, taillights, stoplights, blackout marker lights, and blackout stop lights are missing, damaged, or not operational.</p>



T4300E06

Figure 9. Check Lights for Damage and Proper Operation.

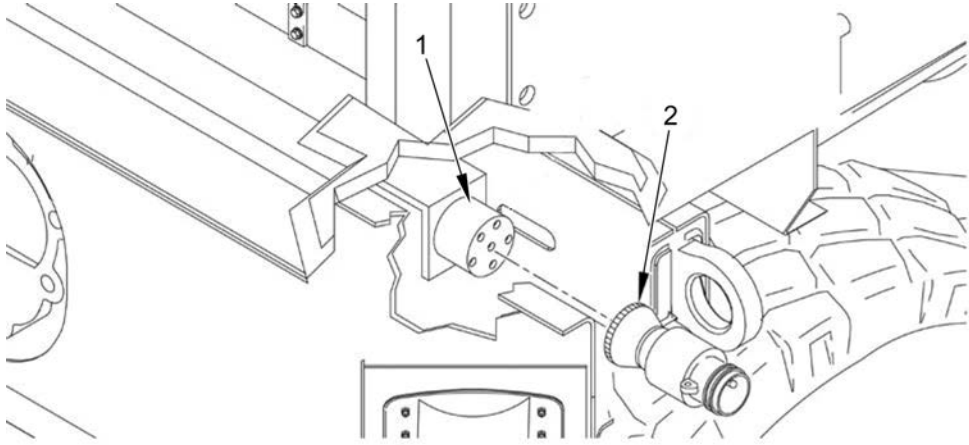
NOTE

If towing vehicle is not FMTV A1, position towing vehicle main light switch to SER DRIVE and depress brake pedal while pressing blink code button as described in step (4).

4. Plug diagnostic tool (Figure 10, Item 2) in socket (Figure 10, Item 1). Press blink code button on diagnostic tool once for one second and release the button. If there are no faults the lamp will go off, come back on and remain on. If there are faults, the tool will flash (blink).

If the ABS diagnostic tool flashes (blinks).

Table 1. PMCS — Before - Continued

ITEM NO.	INTERVAL	ITEM TO BE CHECKED OR SERVICED	PROCEDURE	EQUIPMENT NOT READY/ AVAILABLE IF:
 <p style="text-align: right; margin-right: 50px;">T4300E71</p> <p>Figure 10. Plug Diagnostic Tool in Socket.</p>				

PMCS Mandatory Replacement Parts.

No replacement parts are required for these PMCS procedures.

END OF WORK PACKAGE

**OPERATOR MAINTENANCE
PREVENTATIVE MAINTENANCE CHECKS AND SERVICES — DURING**

INITIAL SETUP:

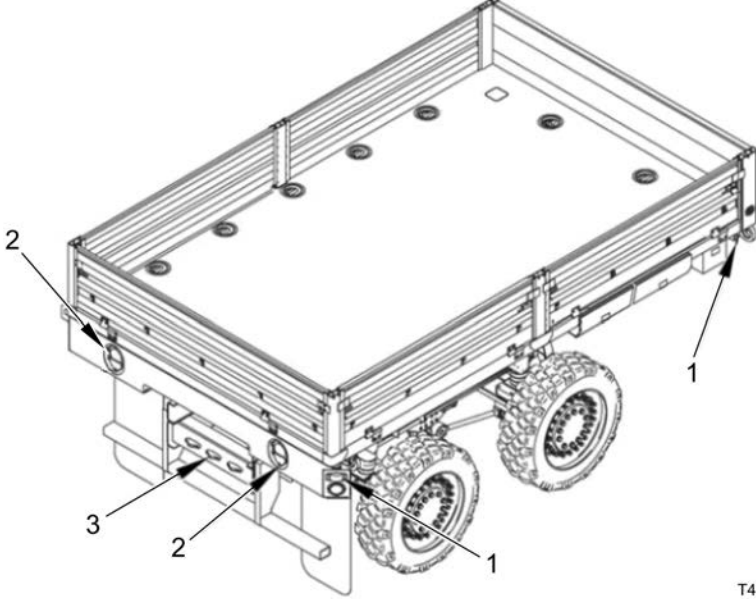
Personnel Required
Operator (2)

References
WP 0001
WP 0006

Table 1. PMCS — During

ITEM NO.	INTERVAL	ITEM TO BE CHECKED OR SERVICED	PROCEDURE	EQUIPMENT NOT READY/ AVAILABLE IF:
1	During	Steering With Trailer Coupled to Towing Vehicle	1. Check for any unusual steering noise, binding, or difficulty in turning during operation.	Steering binds or is unresponsive.
2	During	Service Brakes With Trailer Coupled to Towing Vehicle	1. Check if adequate braking is available to stop trailer during operation. 2. Check if trailer is pulled to one side when brakes are applied during operation. 3. Listen for unusual noises (chattering, grinding, groaning, or excessive squealing) during braking. Notify Field Level Maintenance if unusual noises are present.	System does not provide adequate braking to trailer. Trailer pulls to one side when brakes are applied.
3	During	Wheel Alignment	1. Check tracking for indication of wheel misalignment.	Serious wheel misalignment is present.
4	During	Trailer Lights	1. Check trailer clearance lights (Figure 1, Item 1), marker lights (Figure 1, Item 3), turn signals (Figure 1, Item 2), taillights (Figure 1, Item 2), stoplights (Figure 1, Item 2), blackout marker lights (Figure 1, Item 3), and blackout stop lights (Figure 1, Item 2) for proper operation (WP 0006).	One or more trailer clearance lights, marker lights, turn signals, taillights, stoplights, blackout marker lights, and blackout stop lights are not operational.

Table 1. PMCS — During - Continued

ITEM NO.	INTERVAL	ITEM TO BE CHECKED OR SERVICED	PROCEDURE	EQUIPMENT NOT READY/ AVAILABLE IF:
 <p style="text-align: right; margin-right: 50px;">T4300E1*</p>				
<p>Figure 1. Check Trailer Lights.</p>				

PMCS Mandatory Replacement Parts.

No replacement parts are required for these PMCS procedures.

END OF WORK PACKAGE

**OPERATOR MAINTENANCE
PREVENTATIVE MAINTENANCE CHECKS AND SERVICES — AFTER**

INITIAL SETUP:

Tools and Special Tools

Tool Kit, General Mechanic's
(Volume 2, WP 0210, Table 1, Item 37)

References

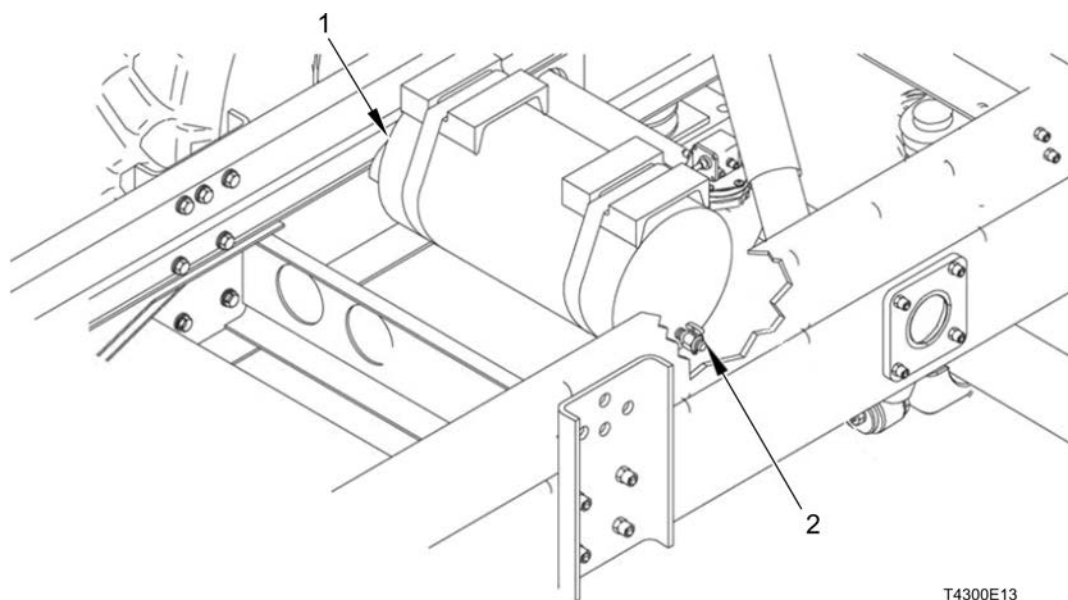
WP 0010
Towing Vehicle Operator Manual (Volume 2, WP 0204)

Personnel Required

Operator (2)

Table 1. PMCS — After

ITEM NO.	INTERVAL	ITEM TO BE CHECKED OR SERVICED	PROCEDURE	EQUIPMENT NOT READY/ AVAILABLE IF:
1	After	Air Tank	1. With trailer parked and towing vehicle engine shut down ((Volume 2, WP 0204), Towing Vehicle Operator Manual), listen for sound of air leaks around trailer air tank (Figure 1, Item 1). 2. Open air tank drain valve (Figure 1, Item 2) and drain moisture (WP 0010).	Air leak(s) heard around air tank.

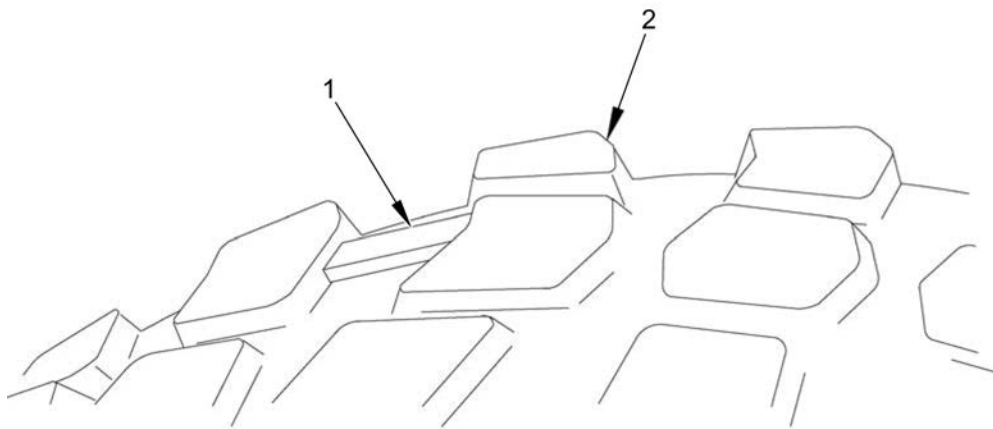


T4300E13

Figure 1. Check Air Tank.

Table 1. PMCS — After - Continued

ITEM NO.	INTERVAL	ITEM TO BE CHECKED OR SERVICED	PROCEDURE	EQUIPMENT NOT READY/ AVAILABLE IF:
2	After	Tires	1. Check for missing tire treads (Figure 2, Item 2) or improperly inflated tires. Check tires for cuts, gouges, cracks, and unusual bulges. Remove any object that could penetrate tire(s).	Tire tread (Figure 2, Item 2) is worn even to height of wear bar (Figure 2, Item 1) (depth is 1/8 in. (0.3 cm) or less). Any cut, gouge, or crack that extends to cord body or any unusual bulges.



T4300E14

Figure 2. Check Tires.

Table 1. PMCS — After - Continued

ITEM NO.	INTERVAL	ITEM TO BE CHECKED OR SERVICED	PROCEDURE	EQUIPMENT NOT READY/ AVAILABLE IF:
3	After	Leaf Springs - MTVT and LMTVT	1. After initial three months of use, notify Field Level Maintenance to tighten U-bolts (Figure 3, Item 1) to 390-510 lb-ft (530-690 N·m), in sequence increments of 50 lb-ft (68 N·m) in crisscross pattern.	

CARGO BED REMOVED FOR CLARITY

T4300E15

Figure 3. Check Leaf Springs - MTVT and LMTVT.

PMCS Mandatory Replacement Parts.

No replacement parts are required for these PMCS procedures.

END OF WORK PACKAGE

**OPERATOR MAINTENANCE
PREVENTATIVE MAINTENANCE CHECKS AND SERVICES — WEEKLY**

INITIAL SETUP:

Tools and Special Tools

Tool Kit, General Mechanic's
(Volume 2, WP 0210, Table 1, Item 37)

Personnel Required

Operator (2)

Table 1. PMCS — Weekly

ITEM NO.	INTERVAL	MAN HOURS	ITEM TO BE CHECKED OR SERVICED	PROCEDURE	EQUIPMENT NOT READY/ AVAILABLE IF:
1	Weekly		Mounting/ Coupling Hardware and Hoses/Tubes	<p style="text-align: center;">NOTE</p> <p>Check bolts, nuts, clamps, hoses, and tubes for looseness and missing, broken, or leaking conditions. Tighten loose bolts, nuts, and clamps. If bolts, nuts, clamps, hoses, or tubes are missing, broken, cannot be tightened, or are damaged to the point of leaking, notify Field Level Maintenance. The following should be checked:</p> <p>1. Air intake system, including SERVICE and EMERGENCY gladhand hoses (Figure 1, Item 1).</p>	
				<p>2. Air storage system, including air tank (Figure 2, Item 1).</p>	

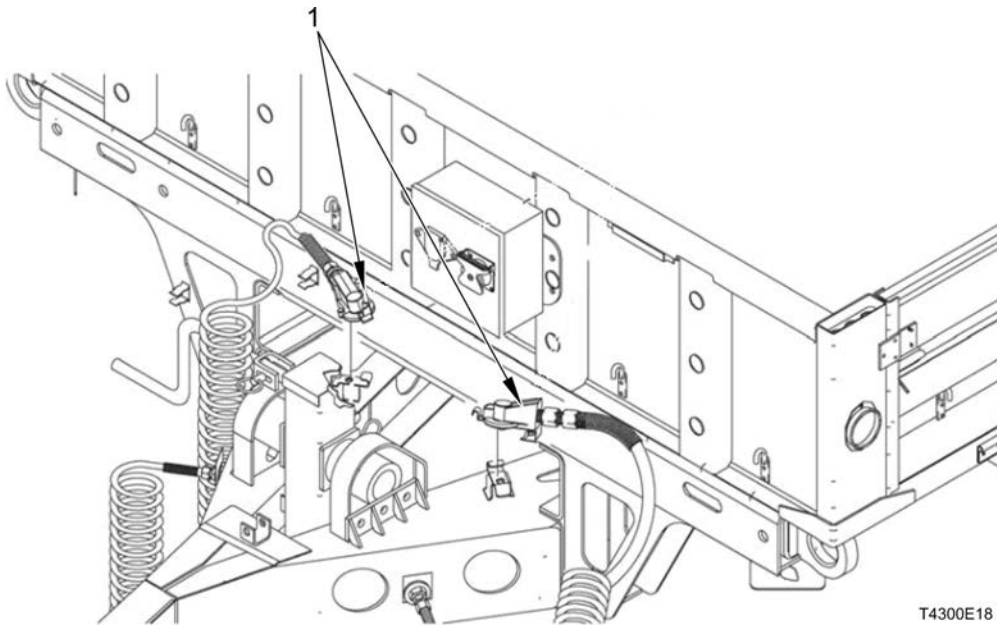


Figure 1. Check Mounting/Coupling Hardware and Hoses/Tubes.

T4300E18

Table 1. PMCS — Weekly - Continued

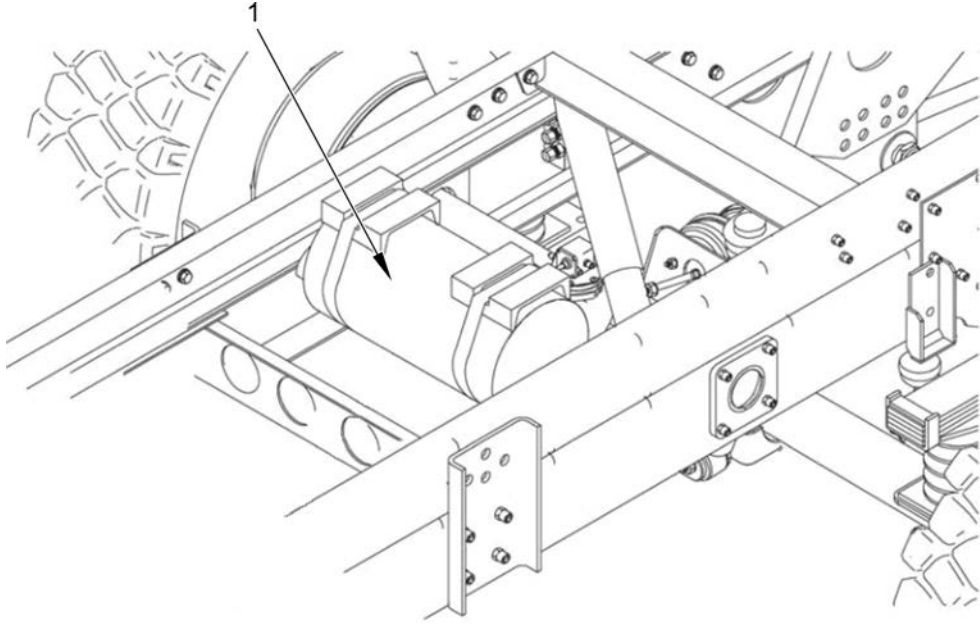
ITEM NO.	INTERVAL	MAN HOURS	ITEM TO BE CHECKED OR SERVICED	PROCEDURE	EQUIPMENT NOT READY/ AVAILABLE IF:
				 <p style="text-align: right;">T4300E16</p>	
			<p>Figure 2. Check Air Storage System and Air Tank.</p>	<p style="text-align: center;">NOTE</p> <p>Check nuts, bolts, clamps, hoses, and tubes for looseness and missing, broken, or leaking conditions. If damage is found, notify Field Level Maintenance.</p> <p>The following should be checked:</p> <p>3. Leaf spring suspension (Figure 3, Item 2), including U-bolts (Figure 3, Item 3).</p> <p>4. Axles (Figure 3, Item 1).</p>	

Table 1. PMCS — Weekly - Continued

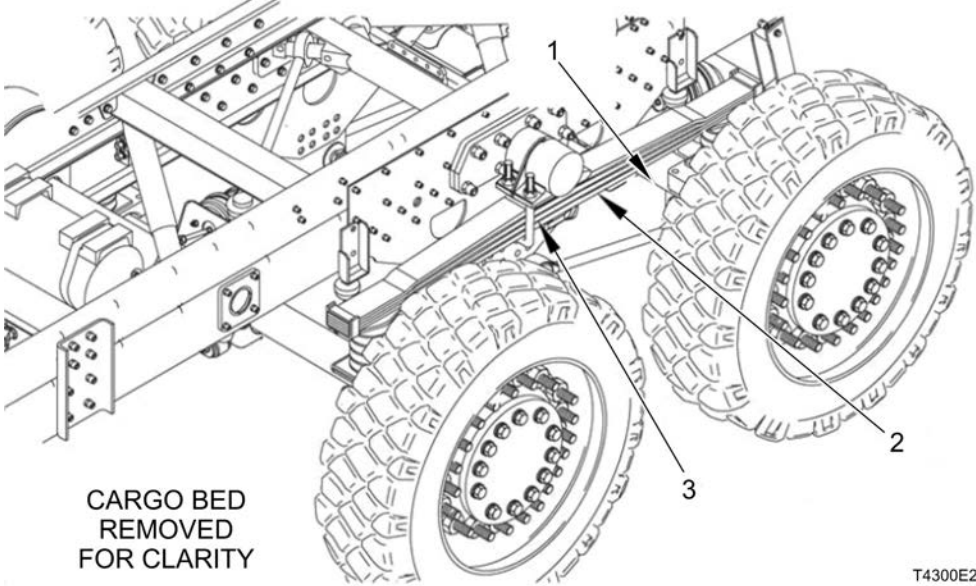
ITEM NO.	INTERVAL	MAN HOURS	ITEM TO BE CHECKED OR SERVICED	PROCEDURE	EQUIPMENT NOT READY/ AVAILABLE IF:
 <p data-bbox="349 877 527 961">CARGO BED REMOVED FOR CLARITY</p> <p data-bbox="1177 955 1258 976">T4300E20</p> <p data-bbox="474 1050 1052 1081">Figure 3. Check Leaf Spring Suspension and Axles.</p>					

Table 1. PMCS — Weekly - Continued

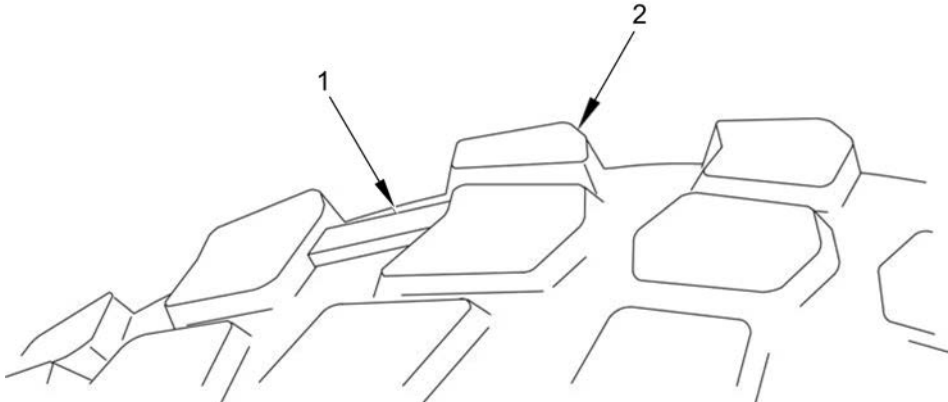
ITEM NO.	INTERVAL	MAN HOURS	ITEM TO BE CHECKED OR SERVICED	PROCEDURE	EQUIPMENT NOT READY/ AVAILABLE IF:
2	Weekly		Wheels and Tires	1. Check tire tread depth (Figure 4, Item 2). Tread depth should not be worn beyond level of wear bar (Figure 4, Item 1).	Tire tread (Figure 4, Item 2) is worn even to height of wear bar (Figure 4, Item 1) (depth is 1/8 in. (0.3 cm) or less). Any cut, gouge, or crack that extends to cord body or any unusual bulges.
 <p style="text-align: right; margin-right: 50px;">T4300E21</p>					
				2. Check wheel assembly for damage. If damaged, remove wheel and check wheel for cracked, broken, or bent surfaces. 3. Check wheel studs (Figure 5, Item 1) and nuts (Figure 5, Item 2) for obvious looseness. Check for bent or broken studs and missing or loose nuts. Notify Field Level Maintenance if any nuts are loose or missing or if any studs are broken or bent.	Wheel is cracked, broken, or bent. Two or more nuts or studs on same wheel are missing, loose, or broken.

Figure 4. Check Tire Tread Depth.

Table 1. PMCS — Weekly - Continued

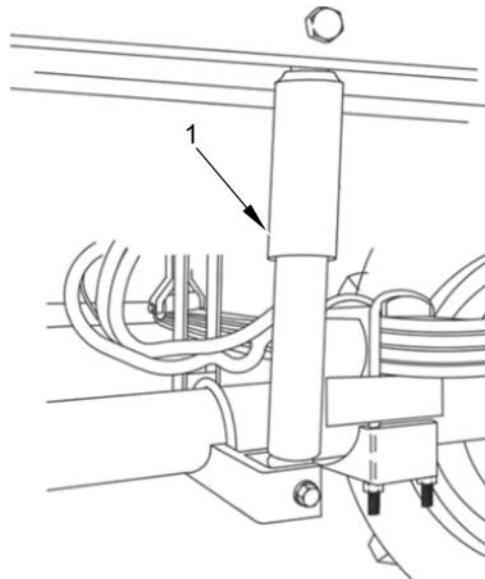
ITEM NO.	INTERVAL	MAN HOURS	ITEM TO BE CHECKED OR SERVICED	PROCEDURE	EQUIPMENT NOT READY/ AVAILABLE IF:
				<p>4. Check tire pressure with tire inflator/ gage for applicable setting.</p> <p>a. BOTH MODELS: HIGHWAY 77 psi (531 kPa).</p>	

Figure 5. Check Wheel Assembly, Studs and Nuts.

T4300E22

Table 1. PMCS — Weekly - Continued

ITEM NO.	INTERVAL	MAN HOURS	ITEM TO BE CHECKED OR SERVICED	PROCEDURE	EQUIPMENT NOT READY/ AVAILABLE IF:
3	Weekly		Underneath Trailer	1. Check underneath trailer for obvious damage to leaf springs, frame rails, and crossmembers. 2. Check air hoses and fittings underneath trailer for obvious damage and leakage. 3. Check shock absorbers (Figure 6, Item 1) for leaks, missing or loose hardware and/or loose shock absorber.	Any loose or broken frame rails, crossmembers, broken welds, or broken screws are found. Any air leaks or damage to hoses or fittings are found. Any oil leaks, missing or loose hardware, or loose shock absorbers are found.



T4300E23

Figure 6. Check Underneath Trailer.

Table 1. PMCS — Weekly - Continued

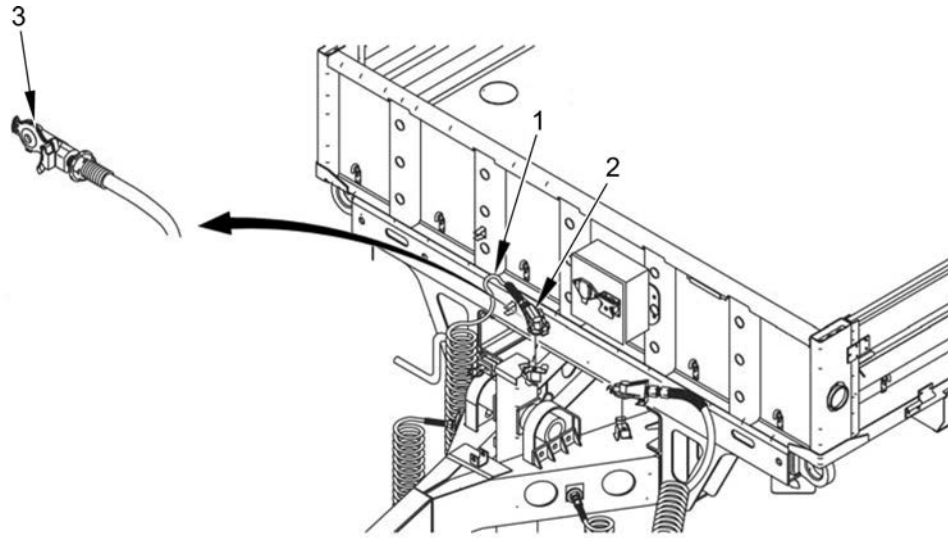
ITEM NO.	INTERVAL	MAN HOURS	ITEM TO BE CHECKED OR SERVICED	PROCEDURE	EQUIPMENT NOT READY/ AVAILABLE IF:
4	Weekly		Electrical Connectors	1. Check electrical connectors and covers (Figure 7, Item 1) for damage.	Electrical connectors are damaged.

T4300E24

Figure 7. Check Electrical Connectors.

Table 1. PMCS — Weekly - Continued

ITEM NO.	INTERVAL	MAN HOURS	ITEM TO BE CHECKED OR SERVICED	PROCEDURE	EQUIPMENT NOT READY/ AVAILABLE IF:
5	Weekly	0.1	Gladhands	1. Check trailer SERVICE and EMERGENCY air hoses (Figure 8, Item 1) and gladhands (Figure 8, Item 2) for damage and air leaks. 2. Check condition of coupler seals (Figure 8, Item 3).	Air leaks are heard. Seals are damaged.

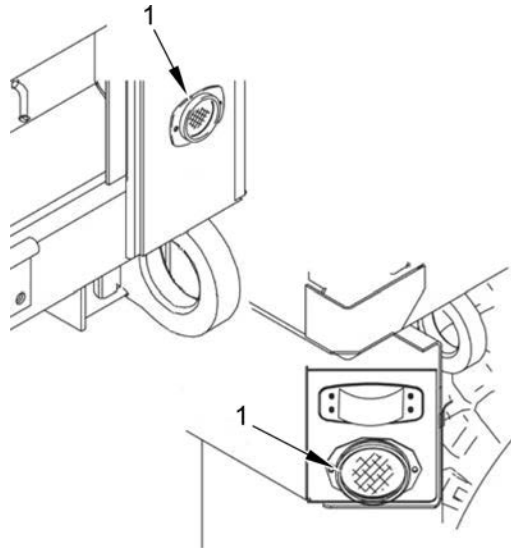


T4300E25

Figure 8. Check Gladhands.

Table 1. PMCS — Weekly - Continued

ITEM NO.	INTERVAL	MAN HOURS	ITEM TO BE CHECKED OR SERVICED	PROCEDURE	EQUIPMENT NOT READY/ AVAILABLE IF:
6	Weekly		Reflectors	1. Check for missing or damaged reflectors (Figure 9, Item 1).	

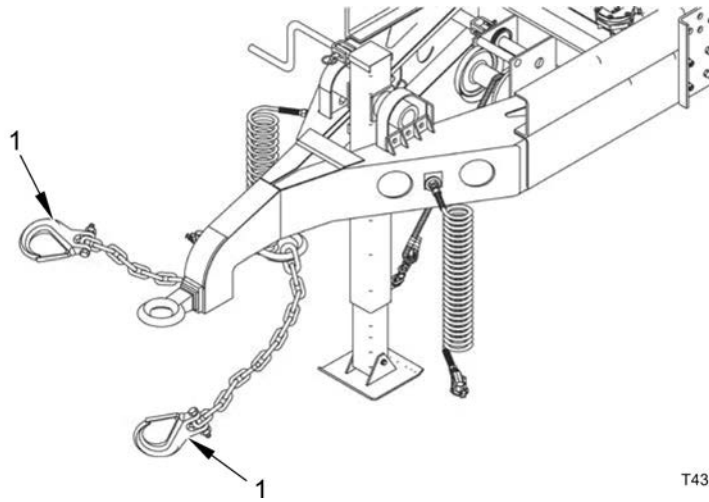


T4300E2E

Figure 9. Check Reflectors.

Table 1. PMCS — Weekly - Continued

ITEM NO.	INTERVAL	MAN HOURS	ITEM TO BE CHECKED OR SERVICED	PROCEDURE	EQUIPMENT NOT READY/ AVAILABLE IF:
7	Weekly		Safety Chains	1. Check safety chains (Figure 10, Item 1) for looseness and/or damaged fastening mechanism.	One or both safety chains are damaged.

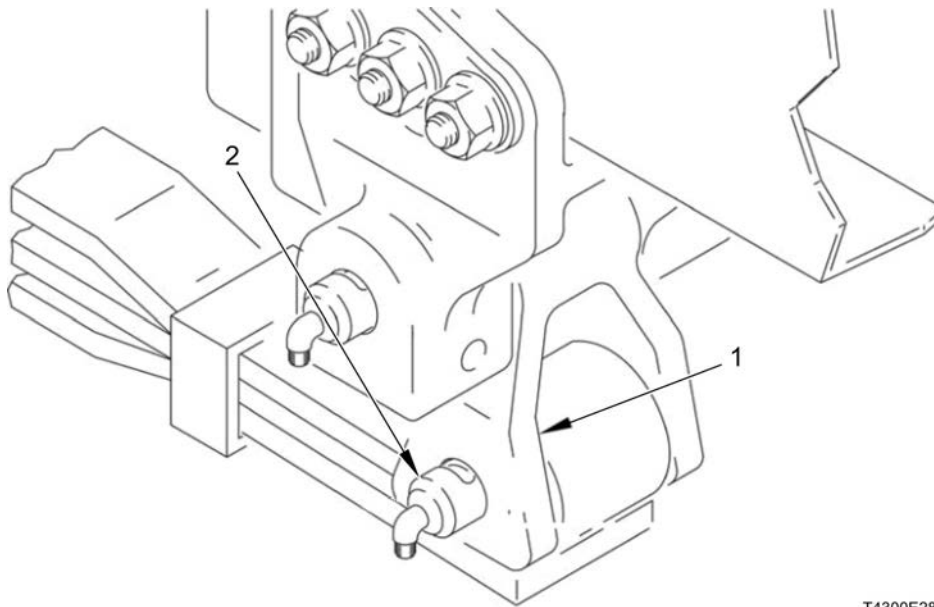


T4300E27

Figure 10. Check Safety Chains.

Table 1. PMCS — Weekly - Continued

ITEM NO.	INTERVAL	MAN HOURS	ITEM TO BE CHECKED OR SERVICED	PROCEDURE	EQUIPMENT NOT READY/ AVAILABLE IF:
8	Weekly		Leaf Spring Brackets/ Shackles (LMTVT).	1. Check leaf spring brackets/shackles (Figure 11, Item 1) for damage. Check spring pins (Figure 11, Item 2) for damage.	One or more leaf spring brackets/ shackles are damaged or missing, and/or one or more spring pins is damaged or missing.



T4300E28

Figure 11. Check Leaf Spring Brackets/Shackles (LMTVT).

Table 1. PMCS — Weekly - Continued

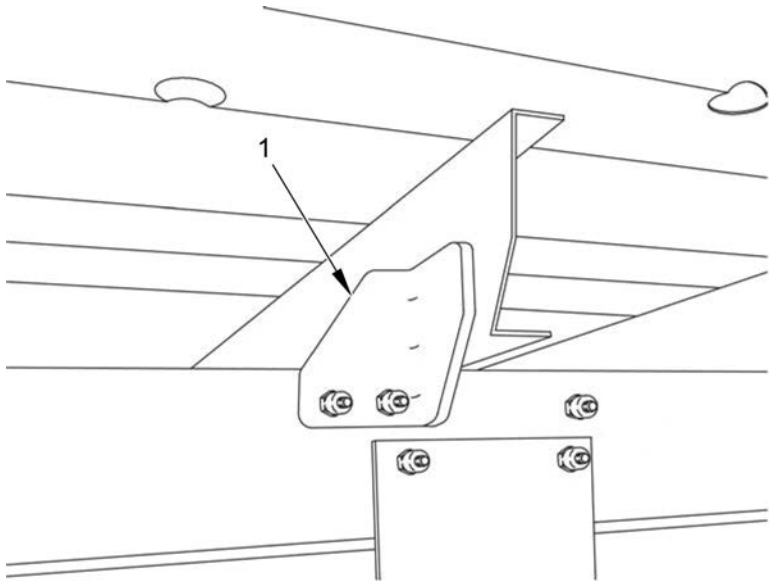
ITEM NO.	INTERVAL	MAN HOURS	ITEM TO BE CHECKED OR SERVICED	PROCEDURE	EQUIPMENT NOT READY/ AVAILABLE IF:
9	Weekly		Cargo Bed	1. Check that cargo bed mounting bolts on trailer sides (Figure 12, Item 1) are not damaged, loose, or missing.	One or more cargo bed mounting bolts is damaged or missing.
					
T4300E29					
Figure 12. Check Cargo Bed Mounting Bolts.				2. Check inside stowage compartments (Figure 13, Item 1) underneath cargo bed for obvious damage.	

Table 1. PMCS — Weekly - Continued

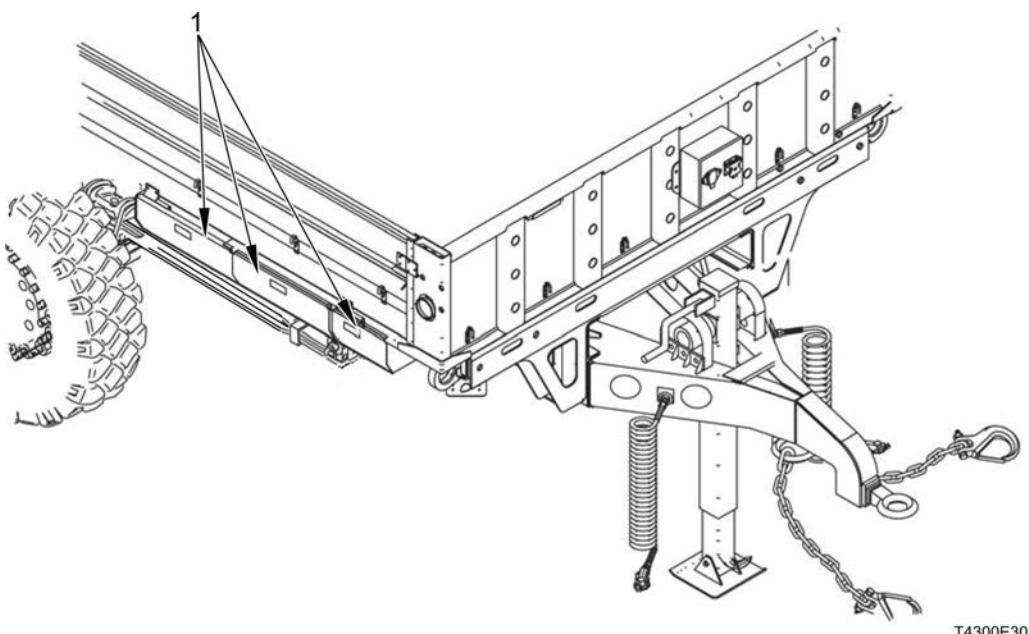
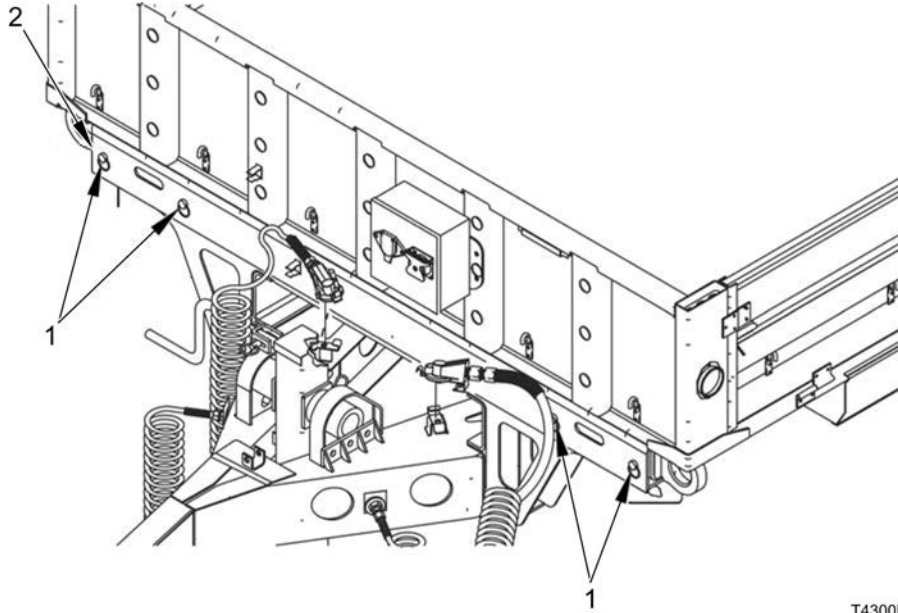
ITEM NO.	INTERVAL	MAN HOURS	ITEM TO BE CHECKED OR SERVICED	PROCEDURE	EQUIPMENT NOT READY/ AVAILABLE IF:
				 <p style="text-align: right;">T4300E30</p>	<p>Figure 13. Check Stowage Compartments.</p> <p>3. Check lifting beams (Figure 14, Item 2) on both sides of trailer for damage. Check that lift beam lock pins (Figure 14, Item 1) are not missing or damaged.</p> <p>Lifting beam is damaged, or lock pin is missing or damaged, and lifting beam is required for trailer mission.</p>

Table 1. PMCS — Weekly - Continued

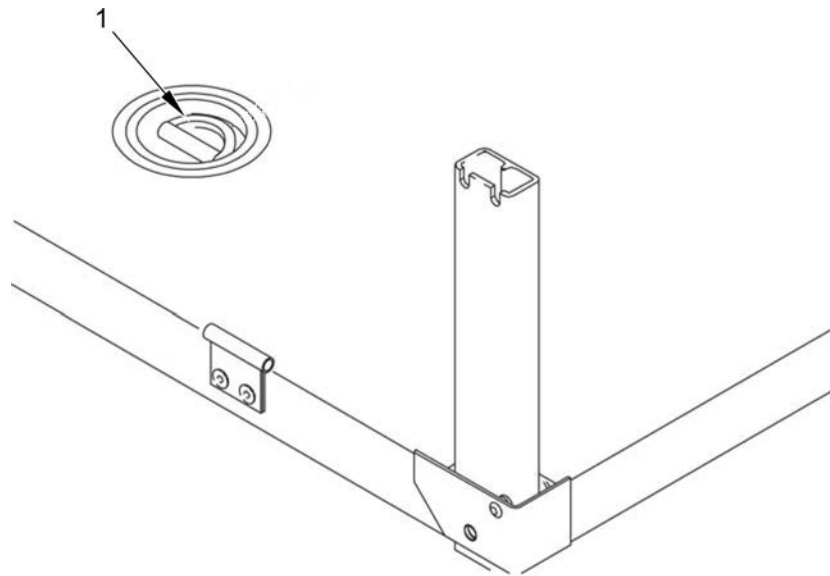
ITEM NO.	INTERVAL	MAN HOURS	ITEM TO BE CHECKED OR SERVICED	PROCEDURE	EQUIPMENT NOT READY/ AVAILABLE IF:
----------	----------	-----------	--------------------------------	-----------	------------------------------------



T4300E31

Figure 14. Check Lifting Beams.

4. Check for missing or damaged cargo bed tiedown rings (Figure 15, Item 1).



T4300E32

Figure 15. Check Tie-Down Rings.

PMCS Mandatory Replacement Parts.

No replacement parts are required for these PMCS procedures.

END OF WORK PACKAGE

**OPERATOR MAINTENANCE
PREVENTATIVE MAINTENANCE CHECKS AND SERVICES — MONTHLY**

INITIAL SETUP:

Materials/Parts

- Grease, Automotive and Artillery (GAA) (Volume 2, WP 0209, Table 1, Item 9)
- Grease, Wire-Rope and Exposed Gear (Volume 2, WP 0209, Table 1, Item 10)
- Oil, Lubricating, Gear, Multipurpose (Volume 2, WP 0209, Table 1, Item 16)
- Oil, Lubricating, OE/HDO-10 (Volume 2, WP 0209, Table 1, Item 15)
- Oil, Lubricating, OE/HD, Arctic (Volume 2, WP 0209, Table 1, Item 14)

Personnel Required

Operator (2)

References

- WP 0009
- FM 10-16 (Volume 2, WP 0204)

Table 1. PMCS — Monthly

ITEM NO.	INTERVAL	MAN HOURS	ITEM TO BE CHECKED OR SERVICED	PROCEDURE	EQUIPMENT NOT READY/ AVAILABLE IF:
1	Monthly		Leaf Springs	1. Check U-bolts (Figure 1, Item 1) and spring pins for damage, looseness, or if missing.	U-bolts and/or spring pins are damaged, loose, or missing.

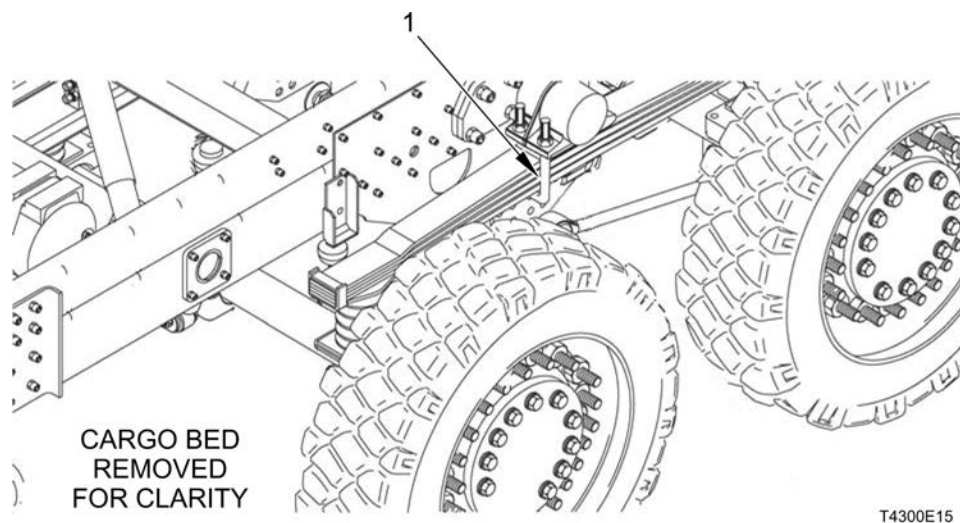
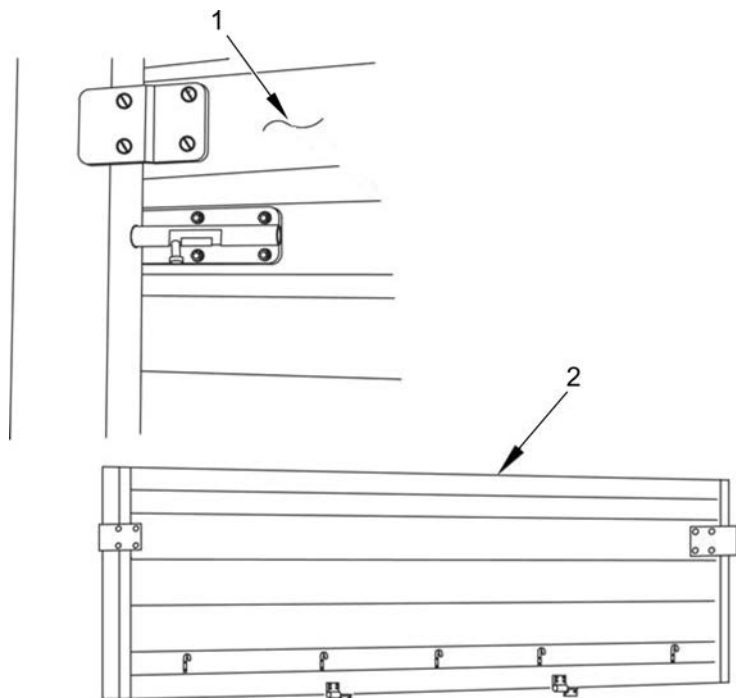


Figure 1. Check U-Bolts and Spring Pins.

Table 1. PMCS — Monthly - Continued

ITEM NO.	INTERVAL	MAN HOURS	ITEM TO BE CHECKED OR SERVICED	PROCEDURE	EQUIPMENT NOT READY/ AVAILABLE IF:
2	Monthly		Cargo Bed Side Panels and Tailgate	1. Check that cargo bed side panels (Figure 2, Item 2) and tailgate (Figure 2, Item 1) are not bent or damaged.	Cargo bed side panels and/or tailgate are bent or damaged and needed for mission.



T4300E34

Figure 2. Check Cargo Bed Side Panels and Tailgate.

NOTE

Hinges and latches on cargo bed side panels and tailgate are the same.

2. Check cargo bed side panels (Figure 3, Item 1) and tailgate hinges (Figure 3, Item 2) for damage and broken welds.

Cargo bed side panels or tailgate hinge is damaged, or weld is broken.

Table 1. PMCS — Monthly - Continued

ITEM NO.	INTERVAL	MAN HOURS	ITEM TO BE CHECKED OR SERVICED	PROCEDURE	EQUIPMENT NOT READY/ AVAILABLE IF:	
			<p data-bbox="516 1066 1198 1094">Figure 3. Check Cargo Bed Side Panels and Tailgate Hinges.</p>	<div data-bbox="373 388 1177 976" style="text-align: center;"> </div> <p data-bbox="1141 976 1218 993">T4300E35</p>	<p data-bbox="771 1129 1226 1281">3. Check cargo bed side panels (Figure 4, Item 2) and tailgate latches (Figure 4, Item 1) for missing or damaged latches. Ensure that latches securely lock cargo bed side panels and tailgate in raised position.</p>	<p data-bbox="1242 1129 1502 1281">Latch is missing, damaged, or does not securely lock cargo bed side panels or tailgate in raised position.</p>

Table 1. PMCS — Monthly - Continued

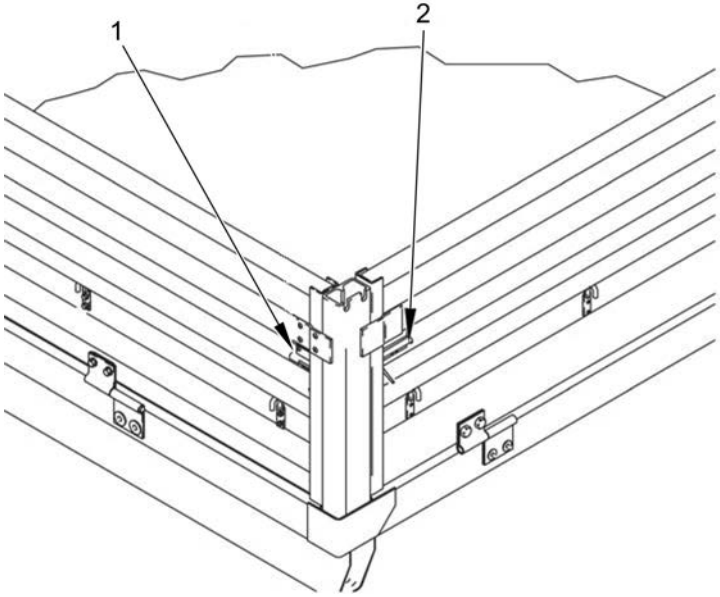
ITEM NO.	INTERVAL	MAN HOURS	ITEM TO BE CHECKED OR SERVICED	PROCEDURE	EQUIPMENT NOT READY/ AVAILABLE IF:
 <p style="text-align: right; margin-right: 50px;">T4300E36</p>					
<p>Figure 4. Check Cargo Bed Side Panels and Tailgate Latches.</p>					

Table 1. PMCS — Monthly - Continued

ITEM NO.	INTERVAL	MAN HOURS	ITEM TO BE CHECKED OR SERVICED	PROCEDURE	EQUIPMENT NOT READY/ AVAILABLE IF:
3	Monthly		Ladder	1. Remove ladder (Figure 5, Item 1) from stowage compartment (WP 0009). 2. Check ladder (Figure 5, Item 1) for cracked or broken welds. 3. Stow ladder (Figure 5, Item 1) in stowage compartment (WP 0009).	

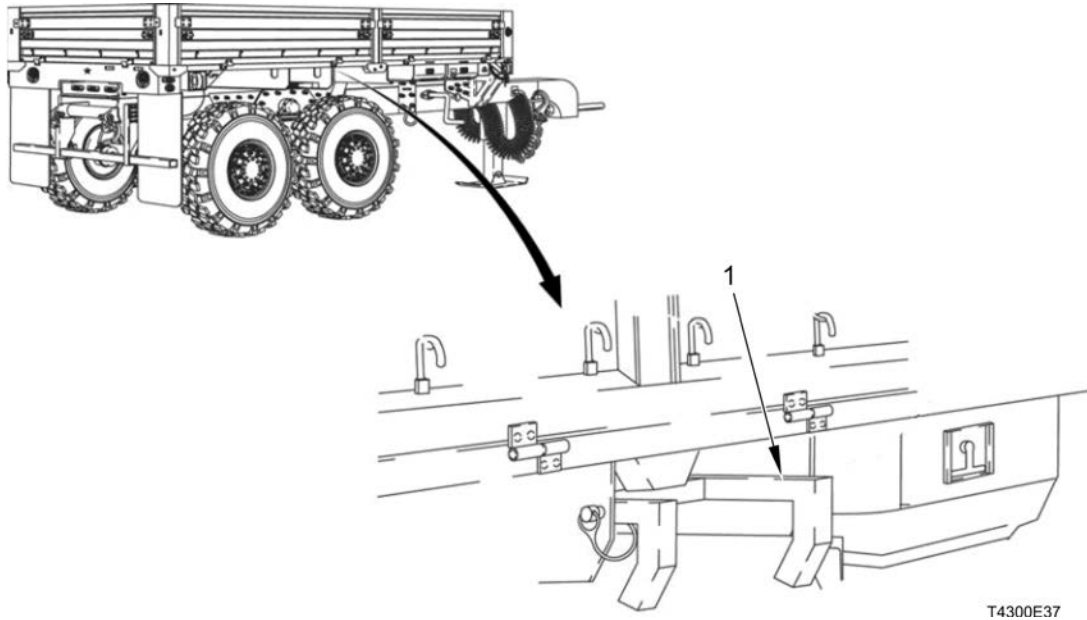


Figure 5. Check Ladder.

Table 1. PMCS — Monthly - Continued

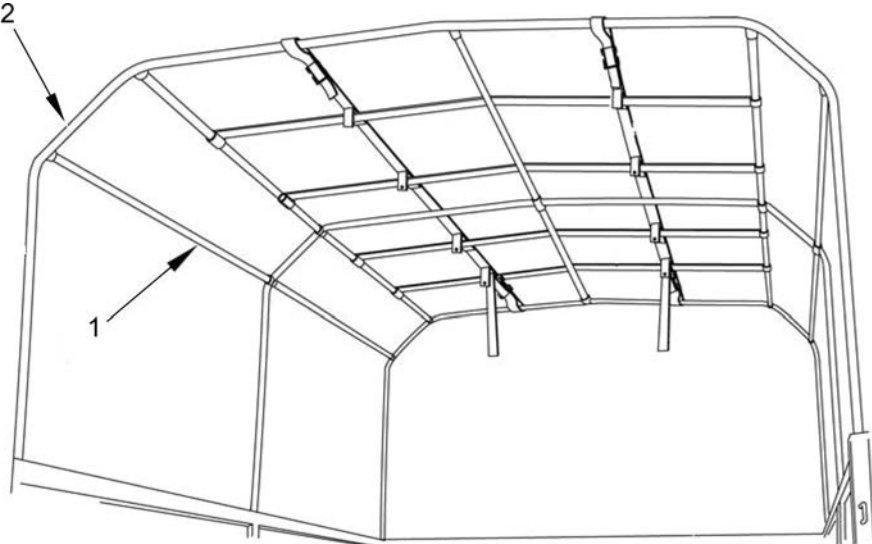
ITEM NO.	INTERVAL	MAN HOURS	ITEM TO BE CHECKED OR SERVICED	PROCEDURE	EQUIPMENT NOT READY/ AVAILABLE IF:	
4	Monthly		Cargo Cover	<p align="center">NOTE</p> <p>Cargo cover is checked before trailer operation only as required to perform trailer mission.</p> <p>1. Check for missing, damaged, or bent bows (Figure 6, Item 2).</p> <p>2. Check for missing, damaged, or bent braces (Figure 6, Item 1).</p>		
<div style="text-align: center;">  <p style="text-align: right; margin-right: 50px;">T4300E72</p> </div> <p align="center">Figure 6. Check Cargo Cover.</p>						
				<p>3. Check cargo cover (Figure 7, Item 1) for tears, punctures, and ripped seams that would interfere with proper operation. If damage is found, notify Field Level Maintenance to repair in accordance with FM 10-16 (Volume 2, WP 0204).</p> <p>4. Check that J-hook (Figure 7, Item 3) used to secure cargo cover tiedown straps (Figure 7, Item 2) is secure and not damaged.</p> <p>5. Check that safety straps (Figure 7, Item 4) are not missing or damaged.</p>		

Table 1. PMCS — Monthly - Continued

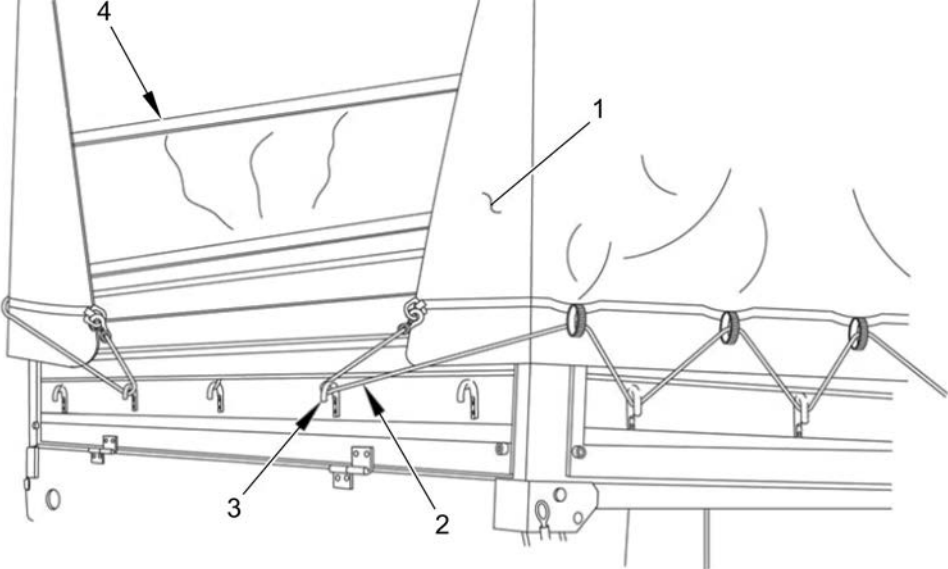
ITEM NO.	INTERVAL	MAN HOURS	ITEM TO BE CHECKED OR SERVICED	PROCEDURE	EQUIPMENT NOT READY/ AVAILABLE IF:
 <p style="text-align: right; margin-right: 50px;">T4300E73</p>					
<p>Figure 7. Check Cargo Cover, J-Hook and Safety Straps.</p>					

Table 1. PMCS — Monthly - Continued

ITEM NO.	INTERVAL	MAN HOURS	ITEM TO BE CHECKED OR SERVICED	PROCEDURE	EQUIPMENT NOT READY/ AVAILABLE IF:																									
5	Monthly	0.1	Oil Can Points	<p>1. Lubricate all oil can points with OE/HDO specified for ambient temperature. The Operator/crew is responsible for lubricating the following points:</p> <table border="1" data-bbox="677 548 1131 1501"> <thead> <tr> <th data-bbox="677 548 980 606">OIL CAN POINTS</th> <th data-bbox="980 548 1131 606">NUMBER</th> </tr> </thead> <tbody> <tr> <td data-bbox="677 606 980 665">Tailgate hinge pins</td> <td data-bbox="980 606 1131 665">2</td> </tr> <tr> <td data-bbox="677 665 980 758">Cargo bed side panel hinge pins</td> <td data-bbox="980 665 1131 758">8</td> </tr> <tr> <td data-bbox="677 758 980 875" rowspan="2">Cargo bed tiedown</td> <td data-bbox="980 758 1131 816">14 (LMTVT)</td> </tr> <tr> <td data-bbox="980 816 1131 875">16 (MTVT)</td> </tr> <tr> <td data-bbox="677 875 980 968">Voltage converter box cover hinge pin.</td> <td data-bbox="980 875 1131 968">1</td> </tr> <tr> <td data-bbox="677 968 980 1060">Side panel stowage box hinge pins</td> <td data-bbox="980 968 1131 1060">2</td> </tr> <tr> <td data-bbox="677 1060 980 1152">Stowage box door hinge pin</td> <td data-bbox="980 1060 1131 1152">1</td> </tr> <tr> <td colspan="2" data-bbox="677 1152 1131 1236" style="text-align: center;">OIL CAN POINTS As Required</td> </tr> <tr> <td colspan="2" data-bbox="677 1236 1131 1295" style="text-align: center;">Expected Temperatures</td> </tr> <tr> <td data-bbox="677 1295 849 1413">Above 40° F (4° C)</td> <td data-bbox="849 1295 980 1413">40° to - 15°F (4° to -26° C)</td> <td data-bbox="980 1295 1131 1413">-15° to - 50°F (-26° to -46° C)</td> </tr> <tr> <td data-bbox="677 1413 849 1501">OE/HDO- 10</td> <td data-bbox="849 1413 980 1501">OE/HDO- 10</td> <td data-bbox="980 1413 1131 1501">OEA</td> </tr> </tbody> </table>	OIL CAN POINTS	NUMBER	Tailgate hinge pins	2	Cargo bed side panel hinge pins	8	Cargo bed tiedown	14 (LMTVT)	16 (MTVT)	Voltage converter box cover hinge pin.	1	Side panel stowage box hinge pins	2	Stowage box door hinge pin	1	OIL CAN POINTS As Required		Expected Temperatures		Above 40° F (4° C)	40° to - 15°F (4° to -26° C)	-15° to - 50°F (-26° to -46° C)	OE/HDO- 10	OE/HDO- 10	OEA	
OIL CAN POINTS	NUMBER																													
Tailgate hinge pins	2																													
Cargo bed side panel hinge pins	8																													
Cargo bed tiedown	14 (LMTVT)																													
	16 (MTVT)																													
Voltage converter box cover hinge pin.	1																													
Side panel stowage box hinge pins	2																													
Stowage box door hinge pin	1																													
OIL CAN POINTS As Required																														
Expected Temperatures																														
Above 40° F (4° C)	40° to - 15°F (4° to -26° C)	-15° to - 50°F (-26° to -46° C)																												
OE/HDO- 10	OE/HDO- 10	OEA																												

Table 1. PMCS — Monthly - Continued


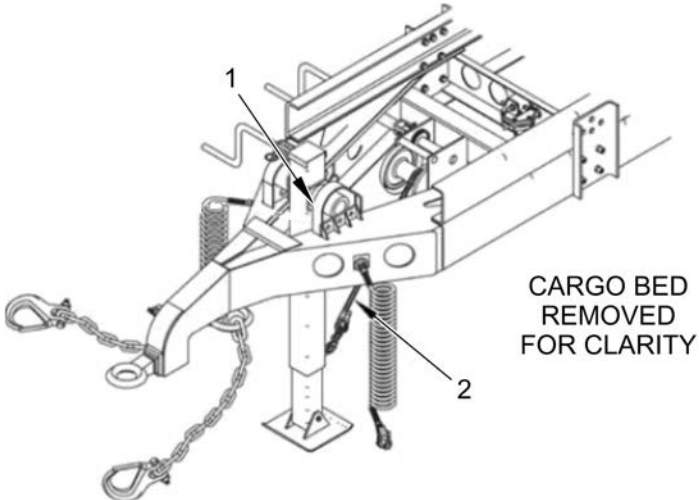
ITEM NO.	INTERVAL	MAN HOURS	ITEM TO BE CHECKED OR SERVICED	PROCEDURE	EQUIPMENT NOT READY/ AVAILABLE IF:
6	Monthly		Landing Gear	<p style="text-align: center;">WARNING</p> <div style="text-align: center;">  </div> <p>Wear heavy leather-palmed work gloves when handling cable. Cables can become frayed or contain broken wires. Never let moving cable slide through hands, even when wearing gloves. Failure to comply may result in injury to personnel.</p> <ol style="list-style-type: none"> 1. Check retractable support mounts (Figure 8, Item 1) for corrosion, cracks, and security of mounting hardware. 2. Pay out winch cable assembly (Figure 8, Item 2) completely and inspect for kinks, sharp bends, abrasions, and broken wires. 	<p>Mounts are excessively damaged due to corrosion or cracks or hardware is loose.</p> <p>Approximately 1/3 of cable strands are broken at any given section.</p>
 <p style="text-align: right;">CARGO BED REMOVED FOR CLARITY</p> <p style="text-align: right;">T4300E3E</p>					
<p>Figure 8. Check Landing Gear.</p>				<ol style="list-style-type: none"> 3. Check that winch drum (Figure 9, Item 1) turns freely and is not damaged. 4. Check that landing gear handle pin (Figure 9, Item 2) is not missing or damaged and is secure. 	<p>Winch drum is damaged.</p> <p>Landing gear handle pin is missing or damaged.</p>

Table 1. PMCS — Monthly - Continued

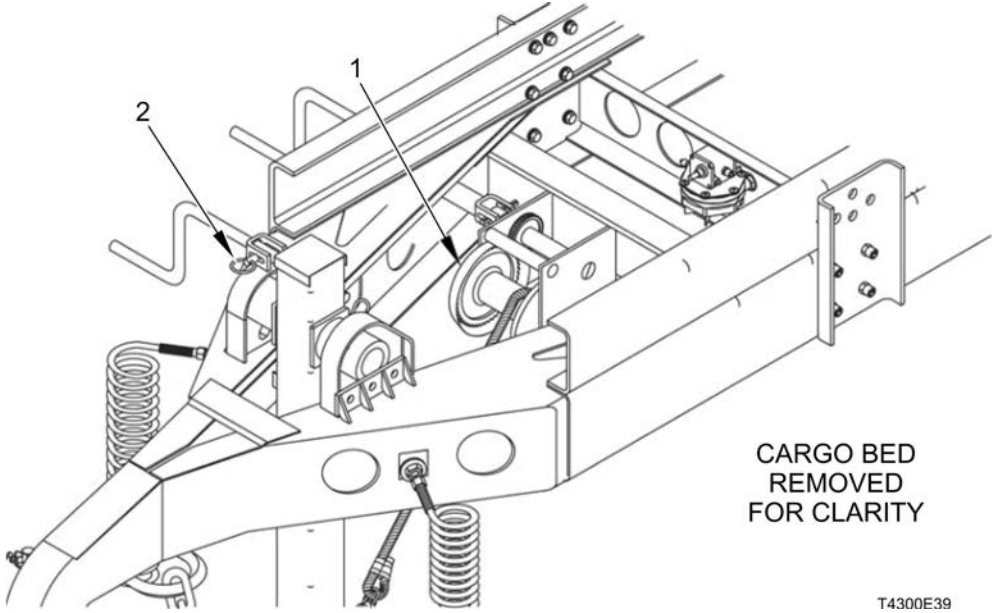
ITEM NO.	INTERVAL	MAN HOURS	ITEM TO BE CHECKED OR SERVICED	PROCEDURE	EQUIPMENT NOT READY/ AVAILABLE IF:
					
<p>Figure 9. Check Winch Drum and Landing Gear Handle.</p>					

Table 1. PMCS — Monthly - Continued

ITEM NO.	INTERVAL	MAN HOURS	ITEM TO BE CHECKED OR SERVICED	PROCEDURE	EQUIPMENT NOT READY/ AVAILABLE IF:												
7	Monthly	0.1	Gladhands	<p>1. Check trailer SERVICE and EMERGENCY air hoses (Figure 10, Item 1) and gladhands (Figure 10, Item 2) for damage and air leaks.</p> <p>2. Check condition of coupler seals (Figure 10, Item 3).</p> <p>3. Lubricate coupler seals (Figure 10, Item 2) with grease (GAA) using a wiping rag.</p> <table border="1" data-bbox="773 667 1222 995"> <thead> <tr> <th colspan="3" data-bbox="773 667 1222 758">OIL CAN POINTS As Required</th> </tr> <tr> <th colspan="3" data-bbox="773 758 1222 821">Temperatures</th> </tr> </thead> <tbody> <tr> <td data-bbox="773 821 943 940">Above 40° F (4° C)</td> <td data-bbox="943 821 1073 940">40° to - 15°F (4° to -26° C)</td> <td data-bbox="1073 821 1222 940">-15° to - 50°F (-26° to -46° C)</td> </tr> <tr> <td data-bbox="773 940 943 995">GAA</td> <td data-bbox="943 940 1073 995">GAA</td> <td data-bbox="1073 940 1222 995">GAA</td> </tr> </tbody> </table>	OIL CAN POINTS As Required			Temperatures			Above 40° F (4° C)	40° to - 15°F (4° to -26° C)	-15° to - 50°F (-26° to -46° C)	GAA	GAA	GAA	<p>Air leaks are heard.</p> <p>Seals are damaged.</p>
OIL CAN POINTS As Required																	
Temperatures																	
Above 40° F (4° C)	40° to - 15°F (4° to -26° C)	-15° to - 50°F (-26° to -46° C)															
GAA	GAA	GAA															

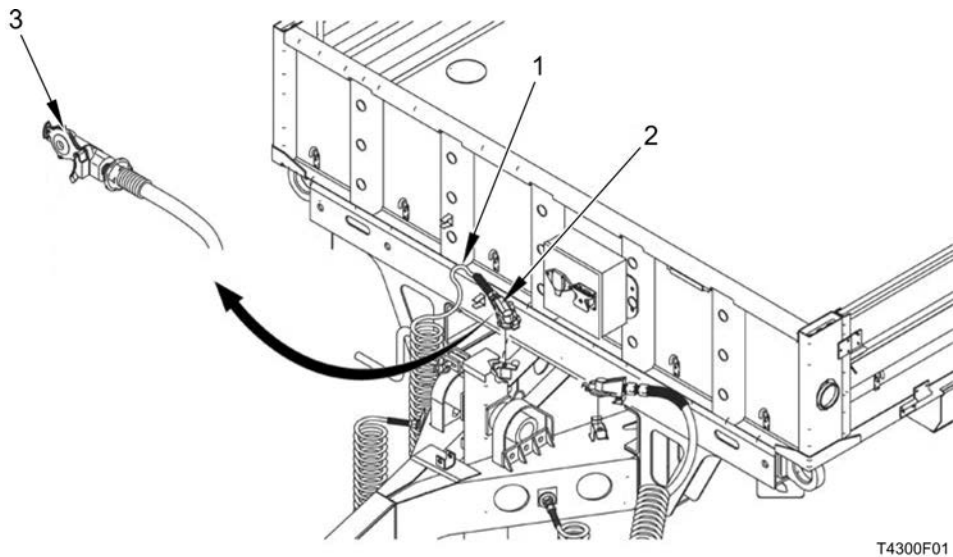


Figure 10. Check Trailer Service and Emergency Air Hoses and Gladhands.

PMCS Mandatory Replacement Parts.

No replacement parts are required for these PMCS procedures.

END OF WORK PACKAGE