

**OPERATOR MAINTENANCE
PREVENTIVE MAINTENANCE CHECKS AND SERVICES (PMCS) PROCEDURES**

INITIAL SETUP:

Materials/Parts

Rap, Wiping (WP 0118, Table 1, Item 9)

References

WP 0005
WP 0037

Personnel Required

Two

Table 1. Operator Preventive Maintenance Checks and Services (PMCS) Procedures.

ITEM NO.	INTERVAL	ITEM TO BE CHECKED OR SERVICED	PROCEDURE	EQUIPMENT NOT READY/ AVAILABLE IF:
			<p style="text-align: center;">NOTE</p> <ul style="list-style-type: none"> • Review WARNING, CAUTION, and NOTE headings before performing PMCS on the trailer assembly. • If operating trailer assembly for the first time, perform Weekly PMCS the first time "Before" PMCS is performed. • Unless otherwise indicated, perform preventive maintenance and lubrication with trailer assembly uncoupled from Prime Mover, parked on level ground, handbrakes applied, and wheels chocked. • Begin walk around inspection at front roadside of trailer assembly and proceed in a counterclockwise direction. 	

Table 1. Operator Preventive Maintenance Checks and Services (PMCS) Procedures - Continued.



ITEM NO.	INTERVAL	ITEM TO BE CHECKED OR SERVICED	PROCEDURE	EQUIPMENT NOT READY/ AVAILABLE IF:
1	Before	LIGHTS AND REFLECTORS	<p style="text-align: center;">NOTE</p> <p>An assistant is required when checking operation of lights.</p> <p>1. Operate Prime Mover light switch through all settings and check lights (Figure 1, Item 1).</p> <div style="text-align: center;">  <p style="text-align: right; margin-right: 100px;">BAE6509</p> </div> <p style="text-align: center;">Figure 1. Intervehicular Cables and Lights and Reflectors.</p>	
2	Before	TIRES	<p style="text-align: center;">WARNING</p> <div style="text-align: center;">  </div> <p>Tire may still be under pressure. Wear eye protection when removing penetrating objects. Failure to comply may result in death or injury to personnel. Seek medical attention in the event of an injury.</p> <p>1. Check tires for cuts, foreign objects, or unusual tread wear.</p> <p>2. Remove any stones or other debris from treads.</p>	Two or more tires on one side of trailer are missing, flat, or unserviceable.

Table 1. Operator Preventive Maintenance Checks and Services (PMCS) Procedures - Continued.

ITEM NO.	INTERVAL	ITEM TO BE CHECKED OR SERVICED	PROCEDURE	EQUIPMENT NOT READY/ AVAILABLE IF:
3	Before	WHEELS	1. Check wheels for damage. 2. Look for loose or missing nuts.	Two or more wheels per axle are damaged. Two or more wheel nuts are missing from any wheel.
4	Before	DRAWBAR RING	Check drawbar ring assembly (Figure 2, Item 1) for secure mounting and obvious damage.	Drawbar ring is loose or bent.
5	Before	INTER-VEHICULAR AIR LINES	Check intervehicular air lines (Figure 2, Item 2) and intervehicular cable (Figure 2, Item 3) for cuts and breaks.	Intervehicular air lines or intervehicular cable broken or missing.
6	Before	INTER-VEHICULAR CABLE	Check intervehicular air lines (Figure 2, Item 2) and intervehicular cable (Figure 2, Item 3) for cuts and breaks.	Intervehicular air lines or intervehicular cable broken or missing.
7	Before	SAFETY CHAIN	Check safety chains (Figure 2, Item 4) for secure mounting and obvious damage.	Safety chains are missing or unsecured.

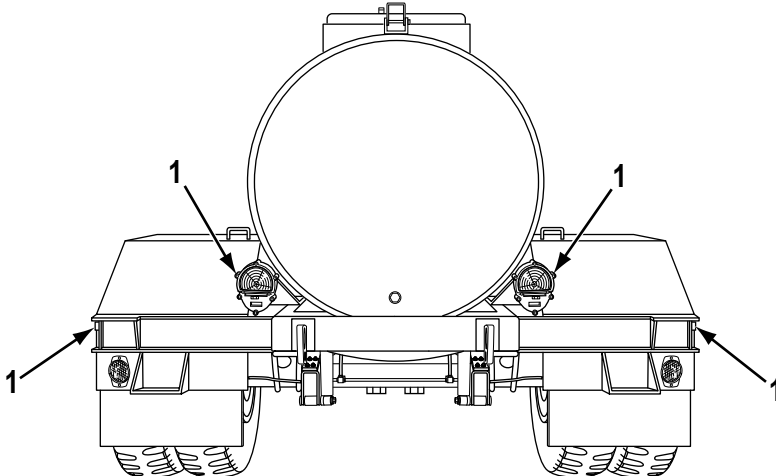

BAE650a6

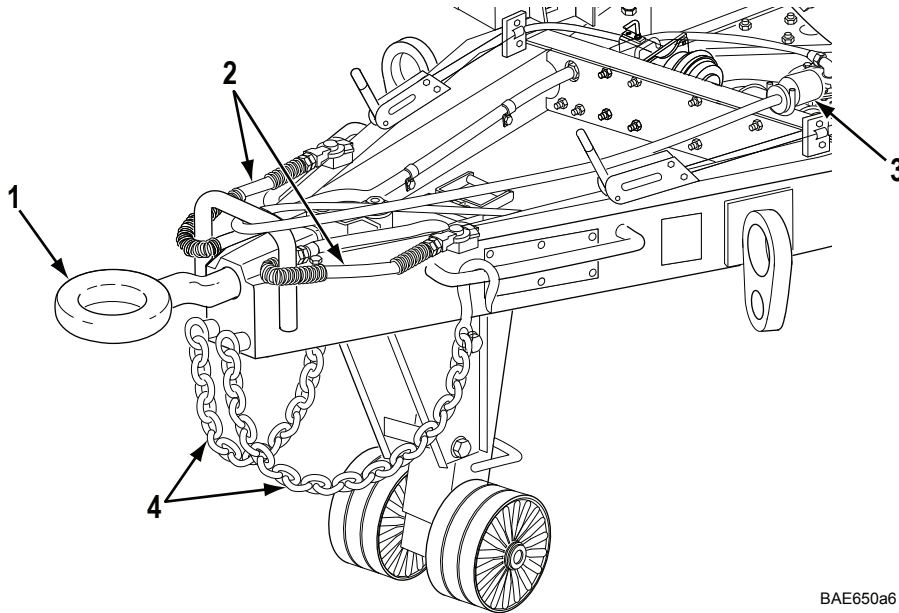
Figure 2. Intervehicular Air Lines and Cable.

Table 1. Operator Preventive Maintenance Checks and Services (PMCS) Procedures - Continued.

ITEM NO.	INTERVAL	ITEM TO BE CHECKED OR SERVICED	PROCEDURE	EQUIPMENT NOT READY/ AVAILABLE IF:
8	Before	BRAKE SYSTEM	<p>Check for fluid leaks at brake drums (Figure 3, Item 3), backing plate assembly (Figure 3, Item 2), master cylinder (Figure 3, Item 4), and hydraulic brake lines (Figure 3, Items 1 and 5).</p>	Class III leaks are found.
 <p>Figure 3. Brake System Components.</p>				
9	Before	AIR LEAK CHECK	<ol style="list-style-type: none"> 1. Couple trailer to Prime Mover and connect all intervehicular air lines (WP 0005). 2. Start Prime Mover and watch air pressure gage for normal reading. Refer to Prime Mover technical manual for instructions. 3. Push Prime Mover brake pedal down to applied position and hold. 4. Shut down Prime Mover engine. 5. Watch Prime Mover air pressure gage for two minutes. If pressure drops more than 10 percent within two minutes, notify Field Maintenance. 	
10	Before	WATER TANK	<p style="text-align: center;">NOTE</p> <p>Moderate amounts of rust on the interior surfaces of stainless steel water tanks used for potable field water storage and transportation generally will not adversely affect the water's potability. Preventive Medicine (PM) personnel who inspect the water tanks should not fail them based solely on the presence of rust unless approximately 25% or more of the interior surface area is rusted.</p>	

Table 1. Operator Preventive Maintenance Checks and Services (PMCS) Procedures - Continued.

ITEM NO.	INTERVAL	ITEM TO BE CHECKED OR SERVICED	PROCEDURE	EQUIPMENT NOT READY/ AVAILABLE IF:
			<p style="text-align: center;">NOTE</p> <p>Tanks must be well rinsed with potable water after disinfecting them, to reduce the chloride concentration in contact with the passive film. Prior to long term storage, any remaining rinse water should be completely removed and the tank interior dried, so the oxygen in the air can keep the passive film intact during storage. welds, imperfections in the alloy, and physical damage can penetrate the protective film and cause rust if for some reason the passive layer does not reform. High chlorine residuals, low pH, and high temperatures all enhance the rates of rusting in Buffalo and Hippo water tanks wherever the passive film has been compromised. The resulting rust may be localized, or it may be spread across the tank's inner surface. Stainless steel thrives on cleanliness. Any dirt, sediment, biological growth, or other conditions that may hinder natural pacification and trap corrosive agents next to the surface should be brought to the attention of the owner/ operator, because they reduce the inherent corrosion protection of the stainless steel.</p> <ol style="list-style-type: none"> 1. When filling, check manhole cover (Figure 4, Item 1), seal, and latch for damage. 2. Check forward faucets curbside and roadside (Figure 4, Item 2) for leakage and proper operation. 	<p>One or more faucets are damaged or missing.</p>

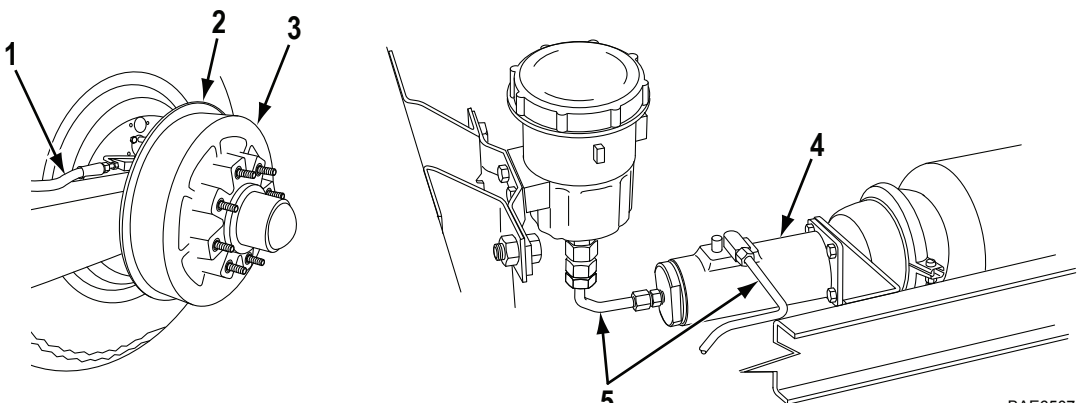
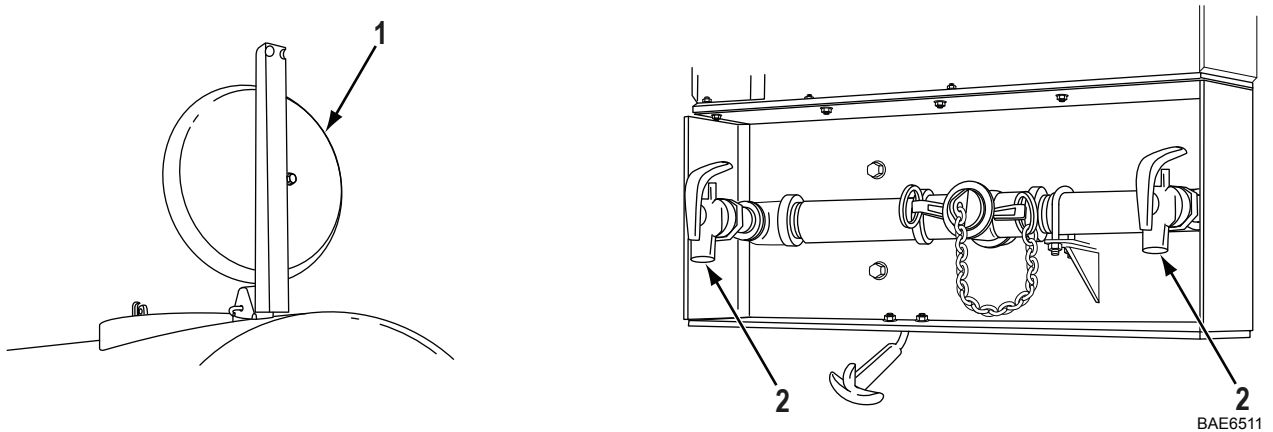
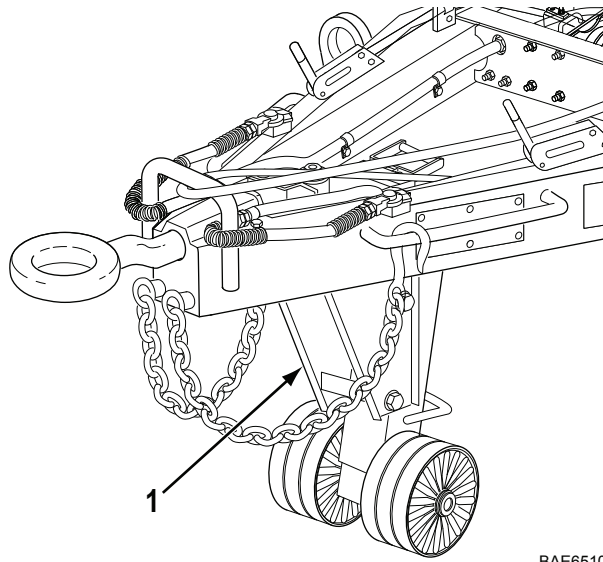

Figure 4. Manhole Cover and Water Valves.

Table 1. Operator Preventive Maintenance Checks and Services (PMCS) Procedures - Continued.

ITEM NO.	INTERVAL	ITEM TO BE CHECKED OR SERVICED	PROCEDURE	EQUIPMENT NOT READY/ AVAILABLE IF:
11	Before	TRAILER	Inspect entire chassis for obvious damage, cracks, or broken welds.	Frame is cracked or has damage.
12	During	LANDING LEG ASSEMBLY	Check landing leg assembly (Figure 5, Item 1) for proper mounting, alignment, and general condition.	Landing leg will not secure in stored position or will not support trailer.



BAE6510

Figure 5. Landing Leg Assembly.

Table 1. Operator Preventive Maintenance Checks and Services (PMCS) Procedures - Continued.

ITEM NO.	INTERVAL	ITEM TO BE CHECKED OR SERVICED	PROCEDURE	EQUIPMENT NOT READY/ AVAILABLE IF:
13	During	BRAKE SYSTEM	<ol style="list-style-type: none"> 1. Test brake system by coupling trailer to Prime Mover. Check hose connections and make sure Prime Mover air valves are turned on. Actuate service brakes. 2. With trailer coupled to Prime Mover, have an assistant actuate service brakes. Listen for air leaks at intervehicular air hoses (Figure 6, Item 1), relay valve (Figure 6, Item 2), and air reservoir (Figure 6, Item 3). 3. Be alert for unusual difficulty in stopping that would indicate service brakes are not working properly. 	<p>Service brakes fail to operate.</p> <p>Air leaks are found.</p>
 <p>Figure 6. Air System Components.</p>				
14	During	TRAILER	<ol style="list-style-type: none"> 1. Be alert for any unusual noises when towing trailer. Stop and investigate any unusual noises. 2. Make sure trailer is tracking/following correctly behind Prime Mover. 	
15	After	HANDBRAKES	<ol style="list-style-type: none"> 1. With trailer coupled to Prime Mover, set handbrakes (Figure 6, Item 4). 2. Move trailer slightly to see if handbrakes hold the wheels. 3. Adjust handbrakes (WP 0037). 	Handbrakes fail to operate or hold trailer.

Table 1. Operator Preventive Maintenance Checks and Services (PMCS) Procedures - Continued.

ITEM NO.	INTERVAL	ITEM TO BE CHECKED OR SERVICED	PROCEDURE	EQUIPMENT NOT READY/ AVAILABLE IF:
16	After	AIR TANK AND FILTER	Apply handbrakes and open drain valve (Figure 7, Item 2) on air reservoir (Figure 7, Item 1) to drain condensation. Close drain valve (Figure 7, Item 2).	
 <p style="text-align: right;">BAE6513</p> <p style="text-align: center;">Figure 7. Drain Valve on Brake Air Reservoir Tank.</p>				
17	Weekly	TIRES	Check to make sure that tire pressure is at 60 psi (413.7 kPa) when tires are cool.	
18	Weekly	LIGHTS AND REFLECTORS	Check for presence and damage to lights and reflectors (Figure 8, Item 1).	
 <p style="text-align: right;">BAE6514</p> <p style="text-align: center;">Figure 8. Reflector Locations.</p>				
19	Weekly	AIR TANK AND FILTER	<ol style="list-style-type: none"> 1. Unscrew pipe plug (Figure 9, Item 2) on air filter (Figure 9, Item 1) and drain condensation from air filter. 2. Clean pipe plug with lint-free rag before installing. 	

Table 1. Operator Preventive Maintenance Checks and Services (PMCS) Procedures - Continued.

ITEM NO.	INTERVAL	ITEM TO BE CHECKED OR SERVICED	PROCEDURE	EQUIPMENT NOT READY/ AVAILABLE IF:
			<p>3. Check air tank for damage and leaks.</p> <div data-bbox="662 436 1052 730" data-label="Image"> <p>Figure 9. Air Filter Drain Plug.</p> </div>	
20	Weekly	WATER TANK	<p>1. Check tank interior for contamination (dirt, rust, paint, or chips).</p> <p>2. Check tank mounting screws and bushings (Figure 10, Item 1) for obvious looseness.</p> <div data-bbox="516 1050 1198 1507" data-label="Image"> <p>Figure 10. Frame to Tank Mounting Hardware.</p> </div>	<p>Contamination is found in tank interior.</p> <p>Tank mounting screws and bushings are missing or loose.</p>

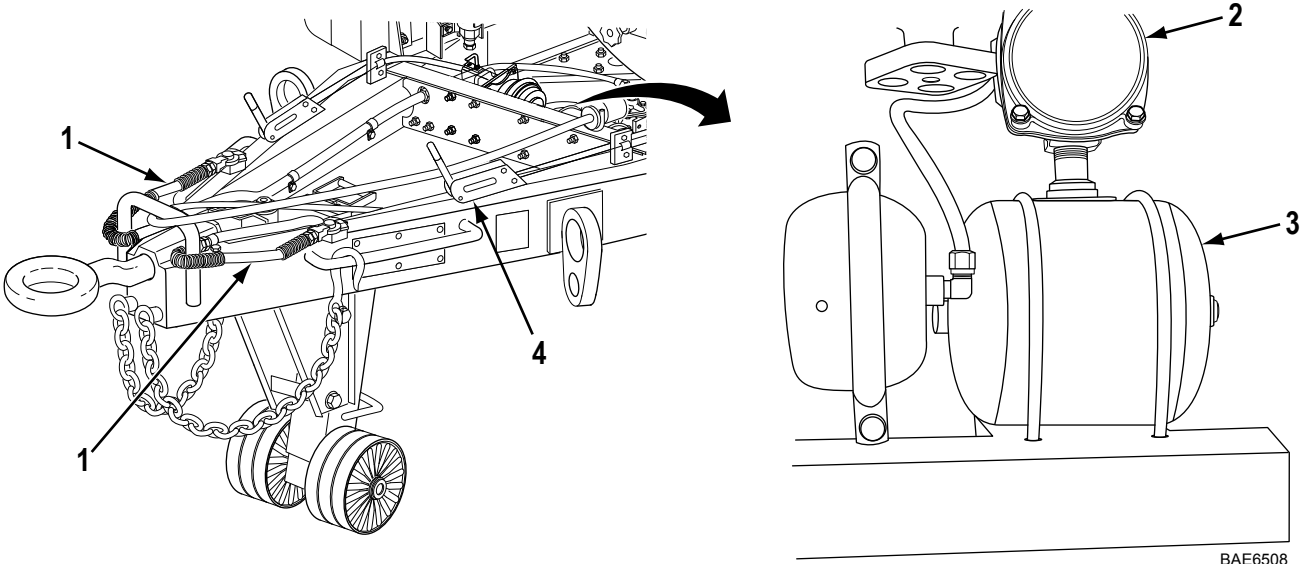
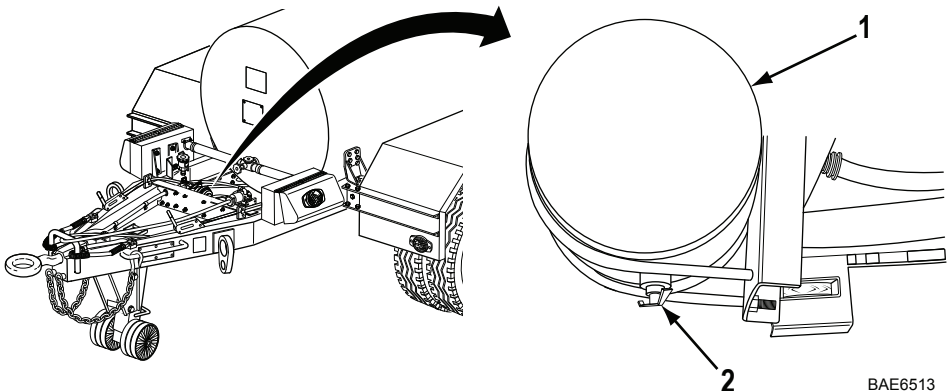
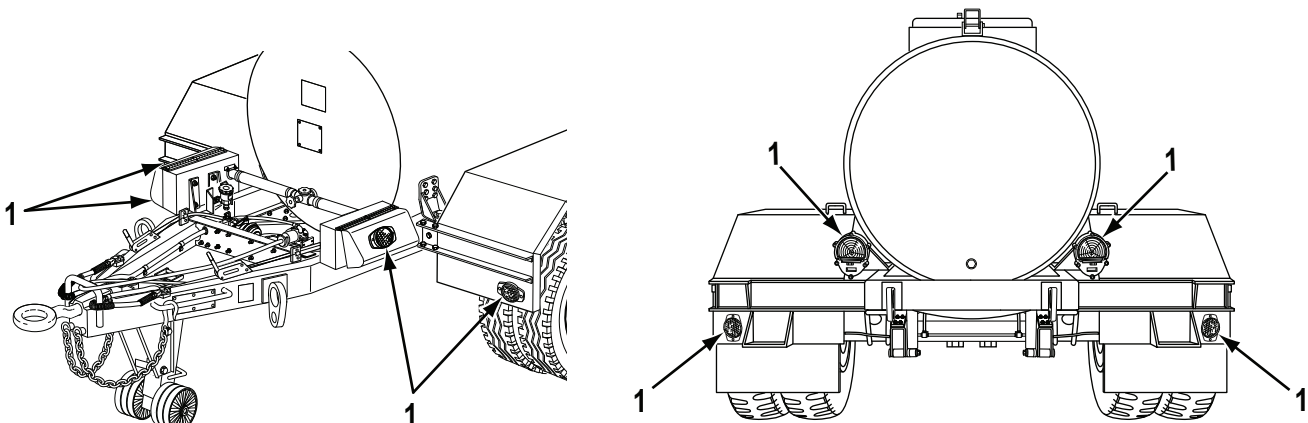
END OF TASK

END OF WORK PACKAGE